

HydroClaw

Tank Washing - Superior Clog Resistance

DESIGN FEATURES

- Clog-resistant design with no moving parts
- Allows passage of particles up to 7 mm diameter, three times the free passage of a comparable spray ball
- Made from FDA compliant 316L stainless steel for use in food-grade and sanitary Clean-In-Place (CIP) applications
- Low pressure/high flow operation.
- Self-draining and self-flushing
- Laser-welded for durability
- Fits through 63.5 or 76 mm diameter opening

Flow rates: 188 - 442 L/min

SPRAY CHARACTERISTICS

- Vigorous rinsing action quickly flushes solids and contamination from vessels
- Complete 360° omni-directional coverage
- Optimum cleaning performance at 2 bar
- Recommended installation 0.6 - 1.0 m vertically below top of tank

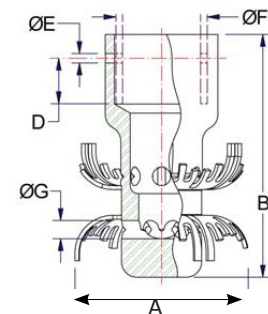

STATIC

Female Connections	Nozzle Number	Litres per minute at Pressure in Bar				Dimensions (mm)					Free pass	Wt (g)	Coverage Diameter @ 2Bar (m)		
		1.5	2	2.5	3	A	B	D	E	F					
3/4" NPT/BSP															
G3/4	HC-42	118	136	152	166	61	91	-	-	-	6.4	375	2.4		
1" Tube Weld-On												300			
1" Tube Clip-On										25.2		325			
DN20 Tube Clip-On	HC-42	125	144	161	176	61	91	19	4	23.1	6.4	350	2.4		
3/4" Pipe Clip-On										26.7		325			
1"NPT												649			
G1	HC100	279	322	360	394	73.2	102	-	-	-	7.62	635	3.05		
1 1/2" Tube Clip-On										38.1		527			
DN40 Tube Clip-On	HC100	312	361	403	442	73.1	102		4.1	40.0	7.62	437	3.05		
1" Pipe Clip-on										33.5		598			