

The logo for SNP (The Spray Nozzle People) is enclosed in a white rounded rectangular border. The letters 'SNP' are in a bold, white, sans-serif font.

SNP

THE
SPRAY NOZZLE
PEOPLE

TANK WASH SOLUTIONS

Metric Catalogue

Updated April 2026



Tank Cleaning Head Comparison Table



THE
SPRAY NOZZLE
PEOPLE

NOZZLE	CLEANING IMPACT	MAX SCRUB DIAMETER (M)	WATER EFFICIENCY	NOTES	MAX SCRUB DIAMETER PER RESIDUE TYPE (M)		
					CLASS 1	CLASS 2	CLASS 3
ROTARY JET							
Orbitor 2	Very high	40.2	High	ATEX options	40.2	32.2	21.2
Orbitor 4	Very high	26	High	ATEX options	26.0	20.8	13.7
Orbitor Dual	Very high	20	High	ATEX options	20.0	16.0	10.6
Orbitor Compact	Very high	17.2	High	ATEX options	17.2	13.8	9.1
Orbitor Eco	Very high	10	High	Fastest cycle	10.0	8.0	5.3
StormBlaster™	Very high	50	Medium-High	Heavy-duty	50.0	40.0	26.4
D3000	Very high	34	High	Heavy-duty	34.0	27.2	18.0
D4000	Very high	51	High	Heavy-duty	51.0	40.8	26.9
ROTARY SPRAY							
RSB	Medium	3.7	Medium-High	360°, 180° down, 270° up	3.7	2.8	1.9
HydroWhirl® Poseidon®	Medium-High	7.6	High	For aggressive chemicals	7.6	5.7	3.8
Spin-Atex Zone 1 & 2	Low-Medium	5.5	High	ATEX cert 1 & 2	5.5	4.1	2.8
Spin-Atex Nano/Micro/Mini/Maxi	Low-Medium	Up to 5 m	High	ATEX cert 0	5.0	3.8	2.5
HydroWhirl Disc	Medium	3.6	Medium-High	Clog resistant	3.6	2.7	1.8
HydroWhirl Stinger (HWS2)	Medium	4	Medium-High	Zirconia ceramic bearings	4.0	3.0	2.0
HydroWhirl Mini SS	Low-Medium	1.8	High	For small vessels, pipes	1.8	1.4	0.9
HydroWhirl Mini PVDF	Low-Medium	1	High	For small vessels, pipes	1.0	0.8	0.5
Kompact	Medium	6	Medium	Small size	6.0	4.5	3.0
EK Pop-up	Low-Medium	Spot cleaning	Medium	Pop-up, supplementary spinner	Spot cleaning	Spot cleaning	Spot cleaning
STATIC							
SVSTW	Low	Rinse up to 6.8	Low	Multi-directional solid stream	6.8	3.4	NA
TW	Low-Medium	2.4	Medium	Small, clog resistant	2.4	1.2	NA
LEM	Low	2.4	Medium	Manifold with 6 TF nozzles	2.4	1.2	NA
Retractor	Depends on head	Depends on head	High (only deployed when needed)	Retractable, ATEX option	Variable	Variable	Variable
HydroClaw™	Low-Medium	3.05	Medium	Clog resistant	3.1	1.5	NA
CLUMP	Low-Medium	3.05	Medium	Stationary manifold	3.1	1.5	NA

Table of Contents



THE
SPRAY NOZZLE
PEOPLE

	PAGE
Introduction to Tank Washing Systems	1
Types of Tank Washing Equipment.....	1
Understanding the Cleaning Process	2
The Cleaning Mix.....	2
Selecting a Tank Cleaner	3-4
Optimising Cleaning Head Performance	5
Rotary Jet Cleaners Introduction	6
Orbitor 2.....	7
Orbitor 4.....	8
Orbitor Dual.....	9
Orbitor Eco.....	10
Orbitor Compact.....	11
Industrial Rotary Jet Cleaners Introduction	12
StormBlaster™.....	13
ScreenBlaster.....	14
D3000 / D4000.....	15
Rotary Spray Cleaners Introduction	16
RSB.....	17
HydroWhirl® Disc.....	18
HydroWhirl® Mini PVDF.....	19
HydroWhirl® Mini SS.....	20
HydroWhirl® Stinger.....	21
HydroWhirl® Poseidon®.....	22
Kompact Clean.....	23
EK Pop-Up.....	24
Spin-Atex Series.....	25
Spin-Atex NANO.....	26
Spin-Atex MICRO.....	27
Spin-Atex MINI.....	28
Spin-Atex MAXI.....	29
Static Cleaners Introduction	30
SVSTW Threaded.....	31
SVSTW Clip-On.....	32
LEM.....	33
CLUMP.....	34
HydroClaw™.....	35
TW Spiral.....	36
Retractor.....	37
IBC Cleaning Kit	38
Custom Cleaning Solutions	39
About Us	40

Introduction to Tank Washing Systems



THE
SPRAY NOZZLE
PEOPLE

Automated tank and vessel cleaning is an essential process across a wide range of industries. The diversity of residues, operating environments and tank sizes demands an equally diverse range of cleaning solutions. The Spray Nozzle People offer a comprehensive portfolio of tank washing nozzles and cleaning machines, suitable for applications ranging from the smallest process vessels to the largest storage tanks. Our solutions are equally effective on everything from light, water-soluble residues to heavy or encrusted deposits.

We work closely with our customers to design and deliver cleaning systems that optimise their processes and provide measurable benefits, including reduced water and energy consumption, lower manual labour and downtime, improved product quality and enhanced protection of company and brand reputation.

In the following pages, we explore the key elements of effective tank cleaning and the critical considerations when selecting the most appropriate system for your application. If you have any questions, our knowledgeable and friendly technical sales engineers are always on hand to provide expert guidance and support.

Types of Tank Washing Equipment

Our range is divided into three main classes (images not to scale):

- 1 Rotary Jet (Pages 6-11):** Rotary jet cleaners can produce jets over 20 m in length, allowing a centrally mounted unit to clean a 40 m diameter tank. These machines are also suitable for small to medium-sized tanks where particularly tough residues need to be removed.



- 2 Rotary Spray (Pages 16-29):** Rotary spray cleaning heads, such as the HWS and HWP, provide greater coverage and moderate impact, making them suitable for cleaning larger vessels up to 7.9 m in diameter. They are capable of handling tougher residues while using less water.



- 3 Static (Pages 30-37):** Static nozzles offer limited coverage and low impact, but they are cost-effective and very robust, as they contain no moving parts.



Understanding the Cleaning Process



THE
SPRAY NOZZLE
PEOPLE

The Cleaning Mix

Effective tank cleaning relies on four elements: **chemical action, time, mechanical action and heat**. Each element contributes to the overall 'cleaning power' of a tank washing operation. Increasing one element allows others to be reduced without compromising results. Conversely, reducing an element must be compensated for by increasing one or more of the others. The contribution of each element varies depending on the type of tank cleaning head or nozzle used, as illustrated in the following Sinner Circle diagrams.

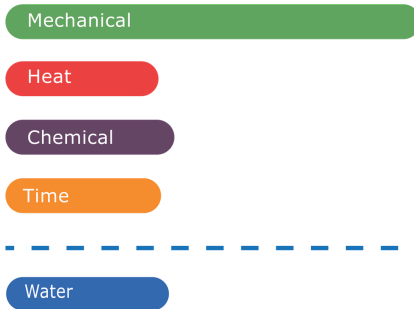
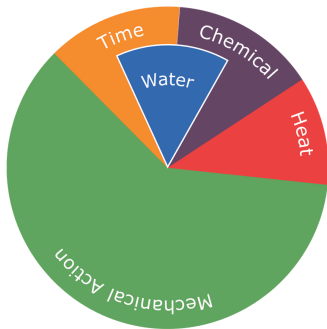

ROTARY JET Pages 6-11

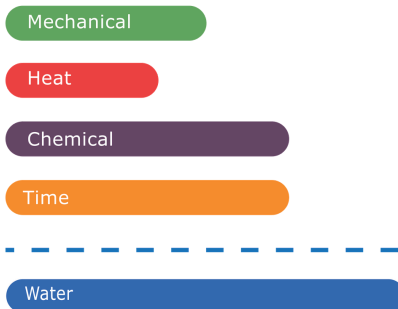
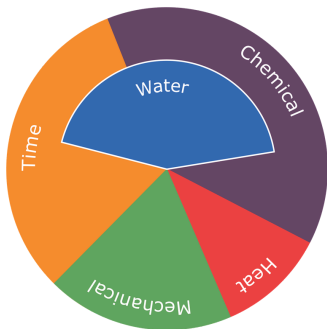

ROTARY SPRAY Pages 16-29

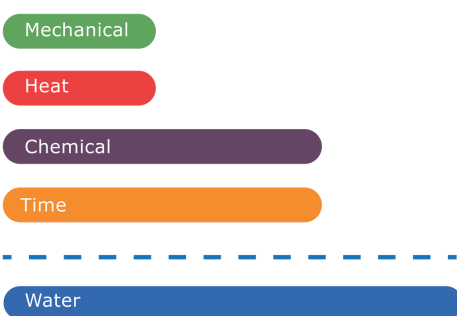
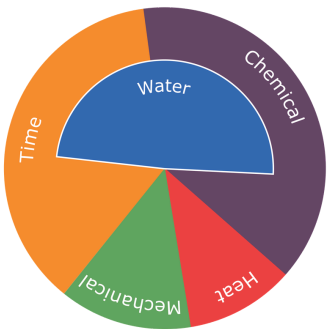

STATIC Pages 30-37



Read our article: *White Paper: Efficient Tank Cleaning*

Scan the QR code or click [HERE](#) to read our article on efficient tank cleaning - how to cut water, chemical, energy use and downtime while improving results.



Selecting a Tank Cleaner



THE
SPRAY NOZZLE
PEOPLE

1. Tank Size

The size of the tank heavily influences which cleaners can be used. Each nozzle or machine has an upper limit to its effective cleaning radius. As tank size increases, the range of suitable cleaning heads narrows. For example, tanks over approximately 10 metres in diameter can generally only be cleaned effectively with rotary jet cleaners.

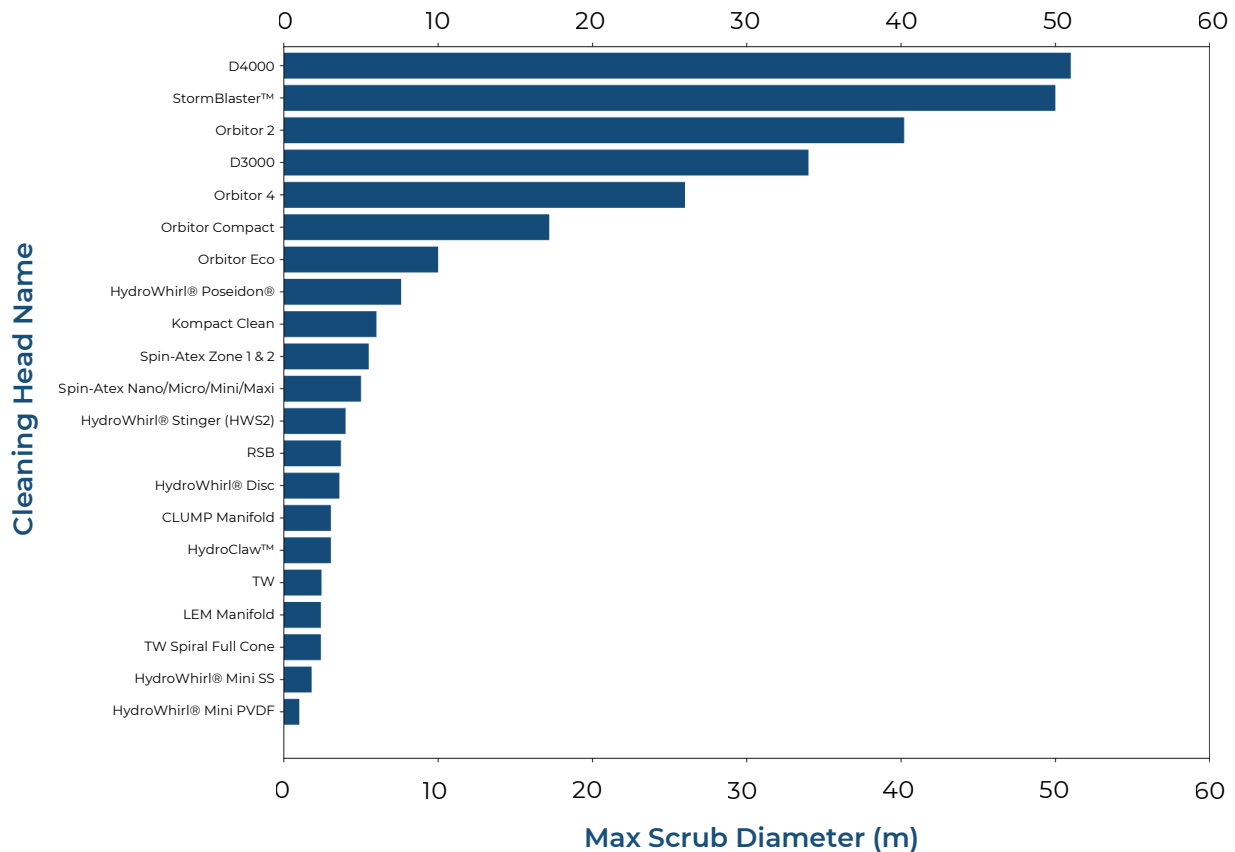

2. Residue Type

We classify residues as light soil, moderate soil and heavy soil:

Class 1 **Light Soil:** A liquid residue or light powder not anchored to the surface and that easily rinses away. Examples: Powder mixes, light chemicals, oil-free liquids.

Class 2 **Moderate Soil:** Soil anchors to the surface and requires repetitive spray impact, temperature, and chemicals to remove. Examples: Beverage concentrates, foods, light oils, dyes, flavourings.

Class 3 **Heavy Soil:** Soil heavily cakes onto the surface, and a longer dwell time is required to aid in the cleaning process. Solid jet streams work effectively on heavy soils. Examples: Paint, asphalt, peanut butter, tar, heavy chemicals, tartrates, oil.

Some residues are easily removed with a simple water rinse, while others require significant impact to dislodge them from the tank walls. While chemical action, time and temperature can compensate to a degree, practical process limits (water consumption, labour, caustic and energy costs etc.) mean that mechanical impact becomes increasingly important for heavier residues. As noted above, however, tank size will govern which cleaning methods can practically achieve that cleaning.

Selecting a Tank Cleaner



THE
SPRAY NOZZLE
PEOPLE

On each nozzle datasheet, you will see a residue suitability legend indicating the residue classes for which the nozzle is typically recommended in practical cleaning applications. As explained on the previous page, tank size and geometry place physical limits on cleaning head selection and must always be considered alongside residue suitability.



TANK CLEANER SELECTION AT A GLANCE

Rotary jet cleaners are generally more water-efficient than rotary spray balls or static systems due to their higher mechanical action. However, smaller tanks may not accommodate larger jet cleaners, and lighter residues may only require gentle cleaning.

Use these rules of thumb when selecting tank cleaning equipment:

1. **Tanks smaller than 1 m** in diameter with medium to light residues: static nozzles are usually most efficient.
2. **Tanks between 1 - 3 m** in diameter with light residues: rotary spray balls are likely most efficient.
3. **Tanks between 1 - 3 m** in diameter with medium or tough residues: fast-cycle rotary jet cleaners, like the Orbitor Eco, are likely most efficient.
4. **Tanks above 3 m**, even with light residues: rotary jet cleaners are probably the most efficient.
5. **Very tough residues**, regardless of tank size: rotary jet cleaners are the most efficient.
6. **Tanks above 6 m** in diameter: rotary jet cleaners are the only viable option, as only they can reach the sides.

3. Tank Environment:

Some environments are particularly challenging - whether abrasive, extremely hot or highly corrosive. In such cases, the standard materials used in our off-the-shelf products may not be suitable. We can manufacture many of our tank cleaners in specialised alloys or plastics to meet these demands, ensuring even the toughest environmental conditions can be overcome.

4. Internal Obstructions:

Baffles, agitators, and other internal structures can obstruct the spray pattern of tank cleaners. This may require the use of multiple machines to ensure full coverage.

READY TO IMPROVE YOUR TANK CLEANING EFFICIENCY AND REDUCE OPERATING COSTS?



Download: *Tank Cleaning System Checklist*

Scan the QR code or click [HERE](#) to download your **FREE** checklist to assess the key factors that impact performance, from tank design and fluid supply to residue type and environmental conditions.



Optimising Cleaning Head Performance



THE
SPRAY NOZZLE
PEOPLE

There are several other factors to consider for effective tank cleaning. Tank size, pump capacity and nozzle positioning are just as important as selecting the best spray cleaning head:

A) Nozzle Placement

The nozzles should be positioned in the upper part of the tank when possible. However, nozzles placed too close to the ceiling of the tank will deflect off the tank ceiling, losing the cleaning impact.

B) Pump Capacity & Size

The pipe size depends on the required flow rate and should be selected to ensure the pressure losses in the pipe system are as low as possible. The required static operating pressure must be directly available at the nozzle and match the pump power. Too much pressure loss in the pipe system may cause poor nozzle performance.

C) Fill Line

When permanently mounting nozzles inside the tank, position them above the fill line. This prevents the nozzle from coming in contact with the product where bacteria build-up and cross-contamination can result. After the cleaning cycle, the nozzle should be removed because bacteria can adhere to the crevices.

D) Tank Diameter Size

As discussed, tanks vary in size and shape, and selecting the appropriate tank cleaning device depends on both the soil type and the vessel diameter. For larger tanks, or those with irregular geometries, we apply a tailored sizing protocol that deploys multiple nozzle heads to ensure complete and effective cleaning.

Guideline for nozzle placement:
(H3) Nozzle = 1/3 Overall Tank Height (H)

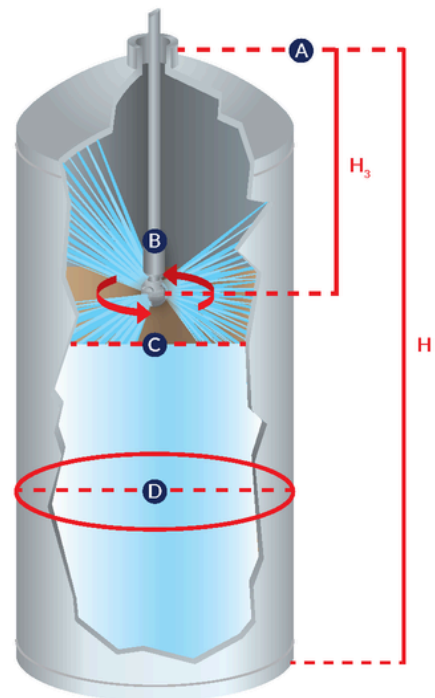

Watch our video series: *CIP Tank Cleaning FAQs: How to Design, Size & Optimise Your System*

Scan the QR code or click [HERE](#) to watch our video series, where we break down the key decisions behind effective tank cleaning - from choosing the right cleaning head and pump to understanding pressure, positioning, cleaning time, water efficiency and overall system cost.



READY TO SPECIFY YOUR APPLICATION?



Download: *Tank Cleaning Application Information Request Form*

Scan the QR code or click [HERE](#) to download and complete our application form to share the key details of your process, helping us recommend the most suitable nozzle for your needs.



Rotary Jet Cleaners Introduction



THE
SPRAY NOZZLE
PEOPLE

Rotary jet cleaning heads, also known as impingement cleaners, are engineered for powerful, precision cleaning. They deliver high-impact jets in a precise, repeating pattern to ensure complete 360° coverage. Our rotary jet cleaners come under our Orbitor range.

Using the cleaning fluid itself to drive internal gearing, the Orbitors rotate high-pressure nozzles in two axes, systematically covering every surface of a tank. The result is a fast, effective and repeatable cleaning cycle - ideal for industries where hygiene, efficiency and reliability are essential. These units are more expensive than other types of tank cleaning head and need to be run at a higher pressure, ideally above 6 bar. However, they are the most cost-effective option in the long run due to their time and water efficiency.

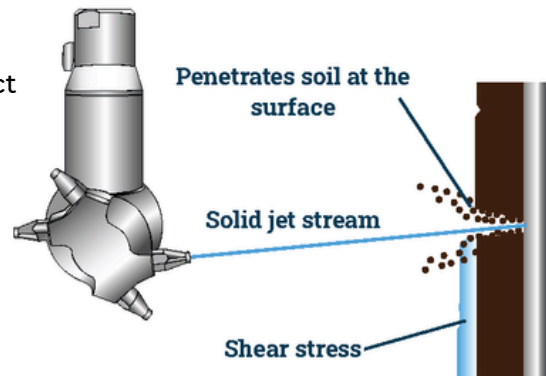

Key Benefits of the Orbitor Rotary Jet Cleaners

- Full 360° cleaning with high-impact jets
- Efficient water usage
- Fluid-driven - no external power required
- Self-cleaning and self-lubricating
- Can be stripped and reassembled in 15 minutes
- Fast cycle times
- ATEX certification available (excluding Eco model)
- Suitable for tanks up to 40 m in diameter
- Achieve:
 - Up to 95% water savings vs. static spray balls
 - Up to 75% water savings vs. rotary spray balls

Cleaning Power

Orbitors can clean tanks from 1-20 m in diameter.

Class 1

Light Soil: The full jet length (see the table under each product) of the rotary jet cleaner can be used, indeed, for many very light residues they can potentially provide an effective rinse action even further than the published jet length.

Class 2

Moderate Soil: We recommend keeping all parts of the tank within 80% of the published jet length. This will ensure there is enough impact to clean the tougher residue.

Class 3

Heavy Soil: We recommend keeping all parts of the tank within 66% of the published jet length to ensure maximum mechanical action is achieved.

The spray pattern builds progressively over a set cleaning cycle, ensuring complete and systematic tank coverage.

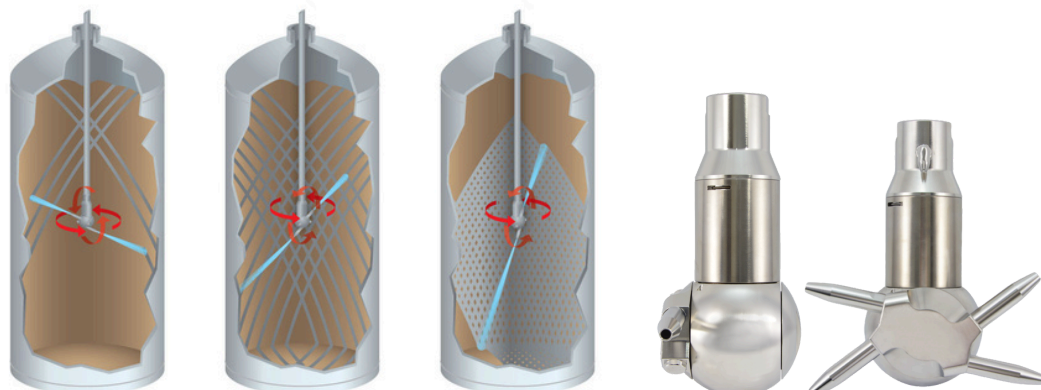

Orbitor 2

2 Nozzle Rotary Jet



THE
SPRAY NOZZLE
PEOPLE



Click [HERE](#) or scan to view this nozzle on our website

Class 1

Class 2

Class 3

Product Overview

The Orbitor 2's two-nozzle configuration means that larger nozzles with higher flow rates can be deployed, extending the jet length to 20 metres.

Design Features

- Operating temperature: Up to 95°C (up to 60°C for ATEX units)
- Construction materials:
 - Housing & Nozzle Head: 316L stainless steel
 - Gears: PEEK + 316 stainless steel
 - Bushings: Carbon-filled PTFE
- Weight: 8 kg
- ATEX-certified options available

Spray Characteristics

- Flow rates: 80-600 L/min
- Working pressure: 3-10 bar
- Jet length: Up to 20 m
- Wash pattern: 360° coverage
- Cycle times: 15.5-33 minutes

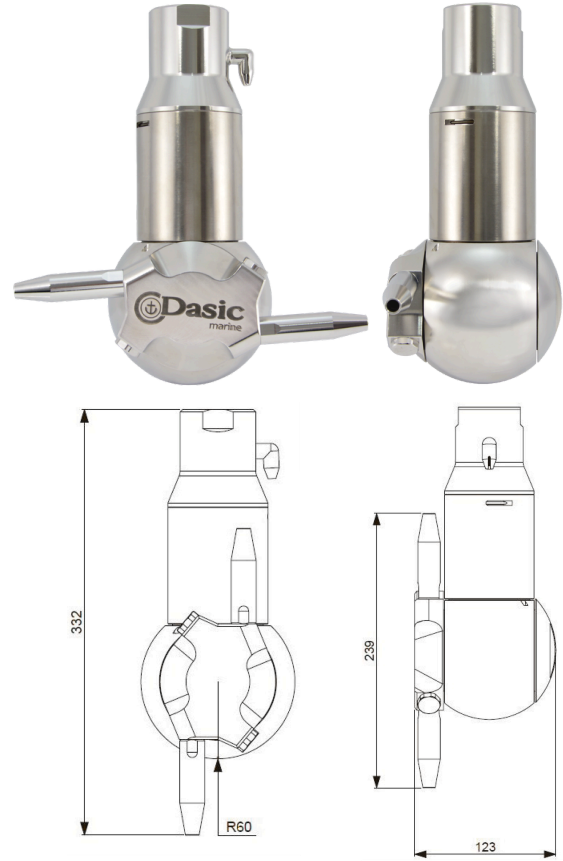

Orbitor 2

Flow Rates, Jet Lengths & Cycle Times

Standard Materials: Housing: 316L | Nozzle Head: 316L | Gears: PEEK + 316 SS | Bushings: Carbon Filled PTFE

Bar	Model Type														
	2x6mm			2x7mm			2x8mm			2x10mm			2x12.5mm		
	Flow rate l/min	Jet Length (m)	Cycle Time (min)	Flow rate l/min	Jet Length (m)	Cycle Time (min)	Flow rate l/min	Jet Length (m)	Cycle Time (min)	Flow rate l/min	Jet Length (m)	Cycle Time (min)	Flow rate l/min	Jet Length (m)	Cycle Time (min)
3	80	5.5	33	93.3	6.5	37.5	117	7.2	25.7	217	9.8	41	330	10.1	26.8
4	91.7	6	27.2	117	7.2	31.6	150	8	22.9	255	10.5	34.2	383	11.2	24
5	108	6.3	24.7	137	7.9	28.2	172	8.7	20.5	290	11.5	30.5	433	12.1	21.7
6	122	7	22.6	153	8.5	25.8	190	9.4	18.9	320	12.7	28	473	13.4	19.8
7	130	8	21	168	9.2	24	203	10.3	17.5	347	13.9	26	512	14.8	18.4
8	140	9	19.5	182	10.4	22.3	213	11.3	16.4	368	15.2	24.5	547	16.4	17.2
9	148	10.2	18.4	192	11.3	21	223	12.4	15.6	390	17	23.2	572	18.3	16.3
10	157	11.5	17.4	200	12.3	20	232	13.5	14.9	405	18.8	22	600	20.1	15.5

Orbitor 4

4 Nozzle Rotary Jet



THE
SPRAY NOZZLE
PEOPLE



Click [HERE](#) or scan to view this nozzle on our website

Class 1

Class 2

Class 3

Product Overview

The four-nozzle configuration provides high-impact cleaning and shorter cycle times. Suitable for medium-to-large tanks requiring thorough and time-efficient cleaning.

Design Features

- Operating temperature: Up to 95°C (up to 60°C for ATEX units)
- Construction materials:
 - Housing & Nozzle Head: 316L stainless steel
 - Gears: PEEK + 316 stainless steel
 - Bushings: Carbon-filled PTFE
- Weight: 8 kg
- ATEX-certified options available

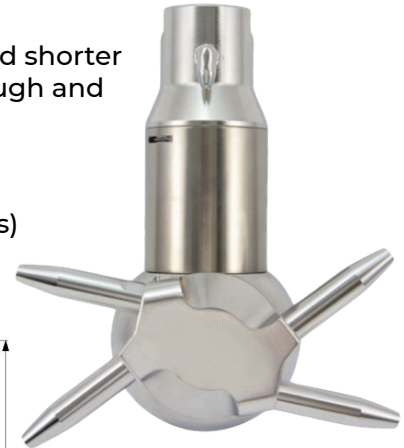

Spray Characteristics

- Flow rates: 80-458 L/min
- Working pressure: 3-10 bar
- Jet length: Up to 13 m
- Wash pattern: 360° coverage
- Cycle times: 5.5-15.5 minutes

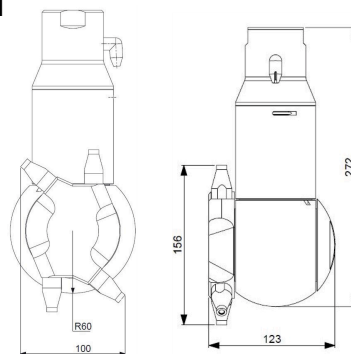

Orbitor 4

Flow Rates, Jet Lengths & Cycle Times

Standard Materials: Housing: 316L | Nozzle Head: 316L | Gears: PEEK + 316 SS | Bushings: Carbon Filled PTFE

		Model Type														
		4x4.2mm			4x5mm			4x6mm			4x7mm			4x8mm		
Bar	Flow rate l/min	Jet Length (m)	Cycle Time (min)	Flow rate l/min	Jet Length (m)	Cycle Time (min)	Flow rate l/min	Jet Length (m)	Cycle Time (min)	Flow rate l/min	Jet Length (m)	Cycle Time (min)	Flow rate l/min	Jet Length (m)	Cycle Time (min)	
3	80	2.9	11	112	4	13	138	5.3	15.5	217	6.5	20.1	250	7.2	15.5	
4	100	3	9.3	137	4.2	10.8	170	5.7	12.9	252	7.1	15.2	293	8	12.9	
5	115	3.5	7.9	155	4.7	9.4	200	6.2	11	283	7.7	14.9	333	9	11	
6	127	4	6.9	173	5.2	8	220	7	9.5	310	8.5	13	367	9.9	9.5	
7	138	5	6.3	185	6.3	7.3	240	8	8.4	333	9.4	11.7	395	10.6	8.5	
8	147	6.2	5.8	195	7.5	6.8	257	9.4	7.6	350	10.3	10.4	418	11.2	7.8	
9	153	7.1	5.6	202	8.5	6.5	270	10.3	7	367	11.2	9.3	438	12.2	7	
10	157	7.8	5.5	207	9	6.4	282	11.2	6.9	380	12	8.9	458	13	6.9	



Watch our short video series: *Comparing CIP Systems*

Scan the QR code or click [HERE](#) to watch our three-part comparison of the main types of tank wash nozzle heads. Discover how spinning spray balls compare with static spray balls, and how both perform against the powerful rotary jet head.



Orbitor Dual

8 Nozzle Rotary Jet



THE
SPRAY NOZZLE
PEOPLE



Click [HERE](#) or scan to view this nozzle on our website

Class 1

Class 2

Class 3

Product Overview

This version with its 8 nozzle configuration provides maximum cleaning density. Its double-head design means that the cleaning pattern can be restricted to as low as 85° without compromising the rotation of the machine.

Design Features

- Operating temperature: Up to 95°C (up to 60°C for ATEX units)
- Weight: 12 kg
- Construction materials:
 - Housing & Nozzle Head: 316L stainless steel
 - Gears: PEEK + 316 stainless steel
 - Bushings: Carbon-filled PTFE
- ATEX-certified options available

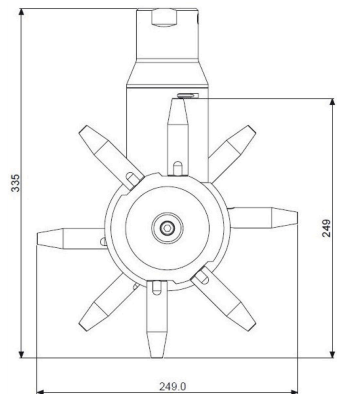

Spray Characteristics

- Flow rates: 85-500 L/min
- Working pressure: 5-10 bar
- Jet length: Up to 20 m
- Wash pattern: 360° coverage (adjustable from 180° to 85° down-wash)
- Cycle times: 6.8-19 minutes

Orbitor Dual Flow Rates & Jet Lengths (based on 180° down wash)

Flow Rates, Jet Lengths & Cycle Times

Standard Materials: Housing: 316L | Nozzle Head: 316L | Gears: PEEK + 316 SS | Bushings: Carbon Filled PTFE

NOZZLE SIZE

Bar	4mm		5mm		6mm		7mm		8mm		9mm	
	Flow rate l/min	Jet Length (m)	Flow rate l/min	Jet Length (m)	Flow rate l/min	Jet Length (m)	Flow rate l/min	Jet Length (m)	Flow rate l/min	Jet Length (m)	Flow rate l/min	Jet Length (m)
5	110	5.0	130	6.0	153	8.0	180	9.0	187	10.0	193	11.0
6	122	6.0	147	7.0	167	9.0	197	10.0	203	11.0	212	12.0
7	125	7.0	125	8.0	182	10.0	212	11.0	218	12.0	225	13.0
8	130	8.0	163	9.0	197	11.0	225	12.0	232	13.0	242	14.0
9	135	9.0	172	10.0	208	12.0	238	13.0	245	14.0	258	15.0
10	140	9.5	180	10.5	217	12.5	250	13.5	260	14.5	275	15.5

Orbitor Eco

4 Nozzle Rotary Jet



THE
SPRAY NOZZLE
PEOPLE



Click [HERE](#) or scan to view this nozzle on our website

Class 1

Class 2

Class 3

Product Overview

The Orbitor Eco is a fast-cycle rotary jet which can complete a cleaning cycle in under two minutes. With such fast cleaning cycles and low flow rates, it is the most efficient way to clean and rinse moderate residues and even tough residues in small tanks such as IBCs.

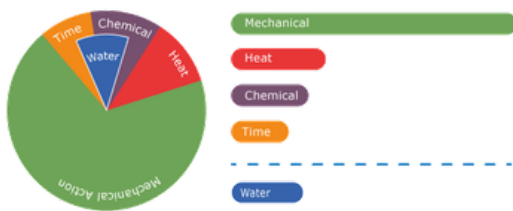

Design Features

- Operating temperature: Up to 95°C (up to 60°C for ATEX)
- Construction materials:
 - Housing & Nozzle Head: 316L stainless steel
 - Gears: PEEK + 316 stainless steel
 - Bushings: Carbon-filled PTFE
- Weight: 2.5 kg

Spray Characteristics

- Flow rates: 45-198 L/min
- Working pressure: 3-10 bar
- Jet length: Up to 5 m
- Wash pattern: 360° coverage
- Cycle times: 1.8-6 minutes

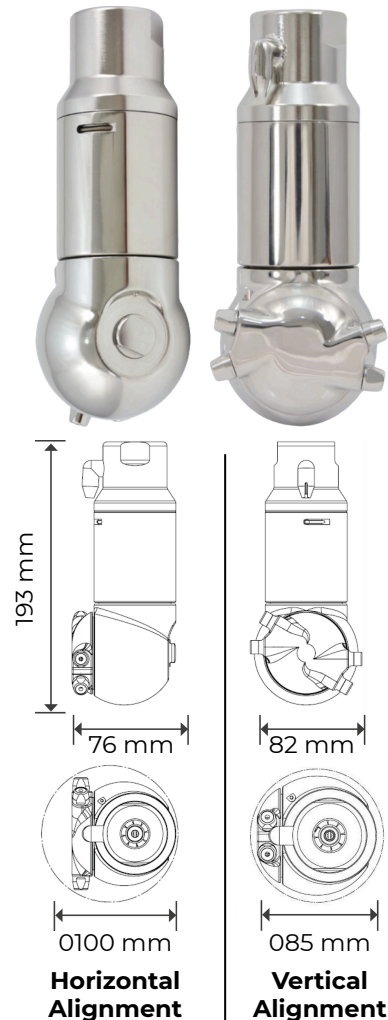

Orbitor Eco

Flow Rates, Jet Lengths & Cycle Times

Bar	Model Type											
	4x3mm			4x4mm			4x5mm			4x6mm		
	Flow rate l/min	Jet Length (m)	Cycle Time (min)	Flow rate l/min	Jet Length (m)	Cycle Time (min)	Flow rate l/min	Jet Length (m)	Cycle Time (min)	Flow rate l/min	Jet Length (m)	Cycle Time (min)
3	45.0	1.0	6.0	66.7	2.0	5.5	88.3	2.5	4.5	115.0	3.0	4.0
4	51.7	1.5	5.5	75.0	2.4	4.8	100.0	3.0	4.0	126.7	3.5	3.5
5	58.3	2.0	5.0	85.0	3.0	4.3	110.0	3.4	3.5	138.3	3.7	3.0
6	65.0	2.3	4.4	93.3	3.3	3.8	120.0	3.6	3.0	151.7	4.0	2.7
7	71.7	2.5	4.0	101.7	3.6	3.3	130.0	4.0	2.8	163.3	4.5	2.4
8	78.3	2.8	3.5	110.0	3.8	2.9	140.0	4.2	2.5	175.0	4.7	2.1
9	85.0	3.0	3.1	118.3	4.0	2.6	148.3	4.5	2.1	186.7	5.0	1.8
10	90.0	3.0	3.0	126.7	4.0	2.5	156.7	4.5	2.0	198.3	5.0	1.8

Orbitor Compact

4 Nozzle Rotary Jet



THE
SPRAY NOZZLE
PEOPLE



Click [HERE](#) or scan to view this nozzle on our website

Class 1

Class 2

Class 3

Product Overview

The Compact can fit through a 100 mm opening and, with arms vertically aligned, through an 85 mm opening suitable for even small tanks or for vessels with narrow openings. It has a geared slow rotation for optimal jet dwell time and superior mechanical action.

Design Features

- Operating temperature: Up to 95°C (up to 60°C for ATEX)
- Construction materials:
 - Housing & Nozzle Head: 316L stainless steel
 - Gears: PEEK + 316 stainless steel
 - Bushings: Carbon-filled PTFE
- Compact body fits through a 100 mm opening
- With arms vertically aligned, fits through an 85 mm opening
- Weight: 2.5 kg
- ATEX-certified options available

Spray Characteristics

- Flow rates: 45-198 L/min
- Working pressure: 3-12 bar
- Jet length: Up to 8.6 m
- Wash pattern: 360° coverage
- Cycle times: 9.5-20 minutes

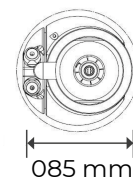
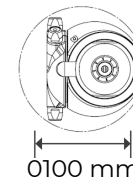
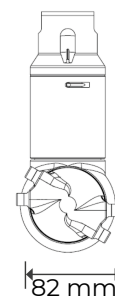
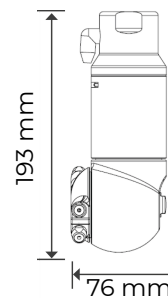

Horizontal Alignment

Vertical Alignment

Orbitor Compact

Flow Rates, Jet Lengths & Cycle Times

Standard Materials: Housing: 316L | Nozzle Head: 316L | Gears: PEEK + 316 SS | Bushings: Carbon Filled PTFE

Bar	Model Type											
	4x3mm			4x4mm			4x5mm			4x6mm		
	Flow rate l/min	Jet Length (m)	Cycle Time (min)	Flow rate l/min	Jet Length (m)	Cycle Time (min)	Flow rate l/min	Jet Length (m)	Cycle Time (min)	Flow rate l/min	Jet Length (m)	Cycle Time (min)
3	48.3	3.7	20.0	61.7	4.3	26.0	90.0	4.9	17.0	115.0	5.4	22.0
4	53.3	4.5	17.0	71.7	5.1	22.0	101.7	5.7	14.0	126.7	6.2	19.0
5	57.5	5.1	14.5	80.0	5.8	19.0	110.0	6.4	12.0	138.3	6.9	16.5
6	64.2	5.6	13.0	90.0	6.4	16.0	120.0	7.0	11.0	151.7	7.4	14.5
7	70.0	6.1	12.0	98.3	6.8	14.0	128.3	7.4	10.5	163.3	7.9	13.0
8	76.7	6.4	10.8	106.7	7.2	12.5	138.3	7.8	10.0	175.0	8.2	12.0
9	83.3	6.7	10.0	113.3	7.5	11.5	146.7	8.0	9.5	186.7	8.5	11.0
10	90.0	6.9	9.5	120.0	7.6	11.0	155.0	8.1	9.5	198.3	8.6	10.0

Industrial Rotary Jet Cleaners Introduction



THE
SPRAY NOZZLE
PEOPLE

Rotary jet cleaning heads are also suitable for heavy industrial cleaning of large, very dirty assets such as stormwater attenuation tanks and Combined Sewer Overflow (CSO) screens.

The StormBlaster™ has been specifically engineered to clean large stormwater retention tanks and similar large-scale vessels. Its powerful, high-capacity jets offer a cleaning reach of up to 25 metres, making it ideal for environments where size, contamination and access are challenges.

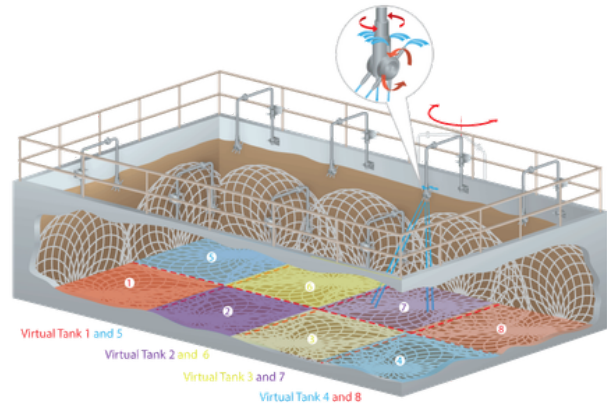

Where tanks exceed 50 m diameter, SNP uses a sizing protocol based on splitting tanks into virtual units (see image above).

These machines are:

- Fully fluid-driven - no external power source needed
- Fully sealed gearbox suitable for particulate-laden fluids (e.g., muds, final effluent)
- Wash-lubricated bearings to prevent cargo contamination
- Rugged stainless-steel construction for durability and minimal maintenance
- Optional grease-lubricated gearbox available
- Available as fixed or portable configuration
- Customisable nozzle sizes and cycle times for specific applications
- Compatible with a wide range of chemicals and product cargos
- Designed for long service life in harsh marine environments

Key Advantages

- **Energy:** By far the most water and energy efficient method of cleaning large tanks and industrial assets
- **Cost:** When compared to the cost of other methods like manned entry, these systems are considerably cheaper in terms of both installation and operating cost
- **Effectiveness:** Remove more residue than other methods, reducing the risk of foul-smelling odours causing complaints from nearby residents.

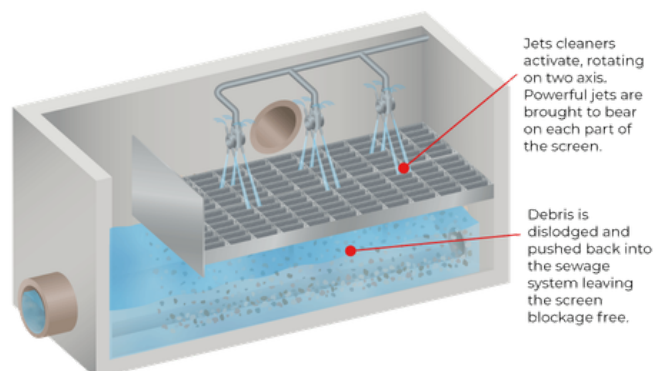
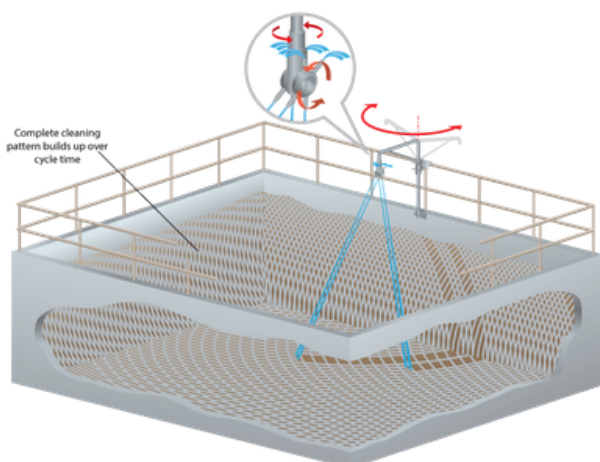

StormBlaster™

2 Nozzle Rotary Jet



THE
SPRAY NOZZLE
PEOPLE



Click [HERE](#) or scan to view this nozzle on our website

Class 1

Class 2

Class 3

Product Overview

The StormBlaster™ has been specifically engineered to clean large stormwater retention tanks and similar large-scale vessels. Its powerful, high-capacity jets offer a cleaning reach of up to 25 metres, making it ideal for environments where size, contamination and access are challenges.

For larger-sized tanks, SNP has developed a sizing protocol which uses multiple StormBlasters to deliver a complete clean.



Design Features

- Construction materials:
 - Housing & Nozzle Head: 316L stainless steel
 - Gears: PEEK + 316 stainless steel
 - Bushings: Carbon-filled PTFE
 - Weight: - 12 kg (6-12 mm) - 14 kg (14 mm)

Spray Characteristics

- Flow rates: 100-570 L/min
- Working pressure: 2-10 bar
- Jet length: Up to 25 m
- Wash pattern: 180° or 360°
- Cycle times: 26-85 minutes

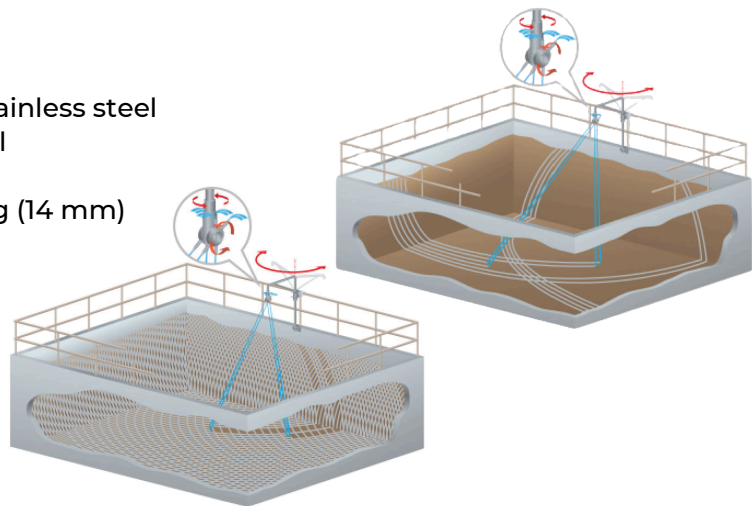

StormBlaster™

Flow Rates, Jet Lengths & Cycle Times

Bar	2x6mm			2x7mm			2x8mm			2x10mm			2x12.5mm			2x14mm		
	Flow Rate l/min	Jet Length m	Cycle Time min	Flow Rate l/min	Jet Length m	Cycle Time min	Flow Rate l/min	Jet Length m	Cycle Time min	Flow Rate l/min	Jet Length m	Cycle Time min	Flow Rate l/min	Jet Length m	Cycle Time min	Flow Rate l/min	Jet Length m	Cycle Time min
2	80	7	85	81	8	85	95	9.5	85	120	10	85	200	10	85	316	11	85
4	98	9.5	50	103	10	50	118	10.5	50	167	11	50	220	11.5	50	341	14	72
6	113	10.5	36	125	11	36	142	12	36	190	13	36	260	14	36	475	18.9	60
8	132	12	29	138	13	29	163	13.5	29	217	14	29	292	15	29	508	22.6	48
10	143	13	26	155	14	26	177	14.5	26	228	15	26	315	17	26	570	25.5	37



Watch our short video series: *The StormBlaster™: Automated Cleaning for Stormwater Tanks*

Scan the QR code or click [HERE](#) to watch our short video series and learn how to keep stormwater attenuation tanks clean, safe and odour-free with the StormBlaster™.



ScreenBlaster

4 Nozzle Rotary Jet



THE
SPRAY NOZZLE
PEOPLE



Click [HERE](#) or scan to view this nozzle on our website

Class 1

Class 2

Class 3

Product Overview

The ScreenBlaster is a versatile rotary jet cleaning machine for cleaning screens such as those found on Combined Sewer Overflow (CSO) systems. Its 8 nozzle design allows the cleaning pattern to be restricted to as low as 90°. This makes it perfect for screen cleaning where very targeted high-intensity cleans are needed.

To overcome shadowing caused by wave design screens, the ScreenBlaster system is designed so that as much as possible of the screen below sits within a 60° cone of the cleaning head. This means that the surfaces within this cone will be hit by jets that are no more than a 30° angle from the horizontal.

Design Features

- Operating temperature: Up to 95°C
- Construction materials:
 - Housing & Nozzle Head: 316L stainless steel
 - Gears: PEEK + 316 stainless steel
 - Bushings: Carbon-filled PTFE
- Weight: 12 kg

Spray Characteristics

- Flow rates: 85-500 L/min
- Working pressure: 5-10 bar
- Jet length: Up to 20 m
- Wash pattern: 90°, 120° or 180°
- Cycle times: 6.8-19 minutes

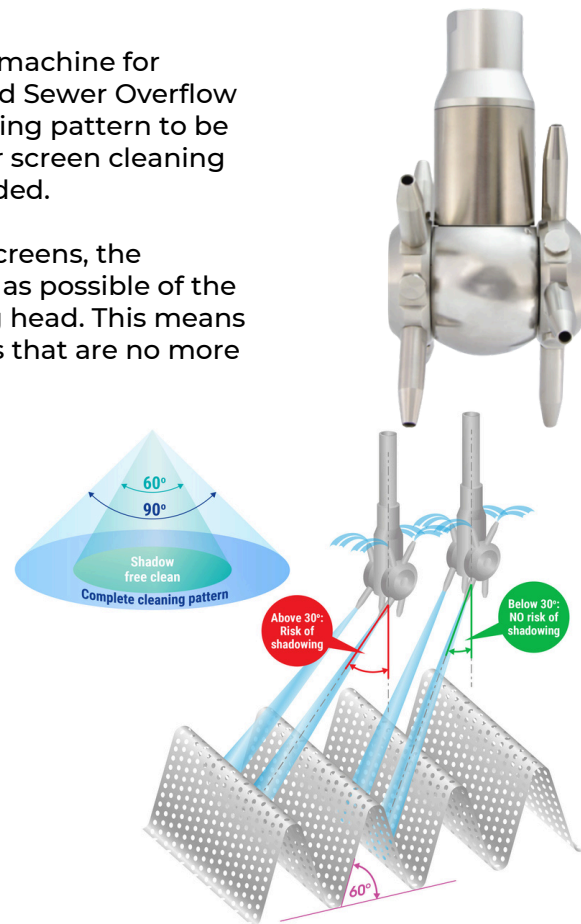

ScreenBlaster Flow Rates & Jet Lengths (based on 180° down wash)

Standard Materials: Housing: 316L | Nozzle Head: 316L | Gears: PEEK + 316 SS | Bushings: Carbon Filled PTFE

Bar	NOZZLE SIZE											
	4mm		5mm		6mm		7mm		8mm		9mm	
	Flow rate l/min	Jet Length (m)	Flow rate l/min	Jet Length (m)	Flow rate l/min	Jet Length (m)	Flow rate l/min	Jet Length (m)	Flow rate l/min	Jet Length (m)	Flow rate l/min	Jet Length (m)
5	110	5.0	130	6.0	153	8.0	180	9.0	187	10.0	193	11.0
6	122	6.0	147	7.0	167	9.0	197	10.0	203	11.0	212	12.0
7	125	7.0	125	8.0	182	10.0	212	11.0	218	12.0	225	13.0
8	130	8.0	163	9.0	197	11.0	225	12.0	232	13.0	242	14.0
9	135	9.0	172	10.0	208	12.0	238	13.0	245	14.0	258	15.0
10	140	9.5	180	10.5	217	12.5	250	13.5	260	14.5	275	15.5



Watch our short video series: *The ScreenBlaster: Efficient Cleaning for Combined Sewer Overflow (CSO) Screens*

Scan the QR code or click [HERE](#) to watch our short video series and discover how the ScreenBlaster system prevents blockages, keeps screens clear and helps stop sewage overflows before they happen.



D3000 / D4000

2 Nozzle Rotary Jet



THE
SPRAY NOZZLE
PEOPLE

Click the links below or scan the QR codes to view these nozzles on our website

Class 1

Class 2

Class 3

Product Overview

The D3000 and D4000 are designed for the demanding cleaning of oil cargo tanks. Both units are lubricated by the wash media and feature an integrated 'Full Tank - Quick Rinse' function within the mechanism. A range of nozzle sizes and cycle times are available to suit different applications. The machines can be supplied as either fixed, permanently installed units or as portable systems. The D3000 is the smaller, more versatile option within the range.



D3000

Design Features

	D3000	D4000
Weight	11 kg	14 kg
Inlet	1.5" BSP / PN10 / 40 flange	2.5" 7.5 TPI male / PN16 / 50 flange
Max Height	241 mm	265 mm
Max Width	150 mm	165 mm
Operating Temp	100°C	
Construction Materials	Body: 316L stainless steel Gears: PEEK Bushings: Carbon-filled PTFE	

Spray Characteristics

	D3000	D4000
Flow Rates	130-560 L/min	86.7-433.3 L/min
Working Pressure	6-10 bar	6-10 bar
Jet Length	Up to 16.9 metres	16.5-25.5 metres
Wash Pattern	360° coverage	
Cycle Times	Various options available	



D4000



BUREAU
VERITAS

Shaping a World of Trust

Approvals: BV

D3000 Flow Rates & Jet Lengths

Bar	Nozzle Size											
	2x6mm		2x7mm		2x8mm		2x9mm		2x10mm		2x12.5mm	
	Flow Rate l/min	Jet Length m	Flow Rate l/min	Jet Length m	Flow Rate l/min	Jet Length m	Flow Rate l/min	Jet Length m	Flow Rate l/min	Jet Length m	Flow Rate l/min	Jet Length m
6	130	11.6	153.3	12.8	210	12.9	241.7	13.9	270	14.2	440	15.5
8	160	13	200	14	250	14.3	283.3	15	320	15.7	520	16.2
10	170	14.5	230	14.9	270	15.2	316.7	15.8	365	16.5	560	16.9

D4000

Flow Rates, & Jet Lengths

Bar	Nozzle Size					
	2x12.5mm		2x14mm		2x16mm	
	Flow Rate l/min	Jet Length m	Flow Rate l/min	Jet Length m	Flow Rate l/min	Jet Length m
6	433.3	16.5	533.3	18.9	691.7	18.9
8	495	18.4	613.3	22.6	790	22.6
10	543.3	19.2	673.3	25.5	866.7	25.5

Rotary Spray Cleaners Introduction



THE
SPRAY NOZZLE
PEOPLE

Also known as spinners, rotary nozzles, or reaction force cleaning heads, these fluid-driven cleaning devices are designed to provide powerful and efficient tank cleaning. Using the reaction force of the cleaning media itself, the nozzle head rotates to deliver a highly effective 360° spray pattern.

Key Benefits

The rotation allows for a more directed and consistent spray to be distributed omnidirectionally, significantly improving cleaning performance through both impact and repetition. This scrubbing action is far superior to that of static spray balls, making rotary nozzles ideal for applications where reliable and thorough cleaning is essential.

Rotary cleaning heads are available in a wide range of models to suit different tank sizes and requirements, including:

- Mini versions for smaller tanks or compact spaces
- Retractable models for installations where clearance is limited
- All-PTFE options, which are particularly suited for harsh or corrosive environments

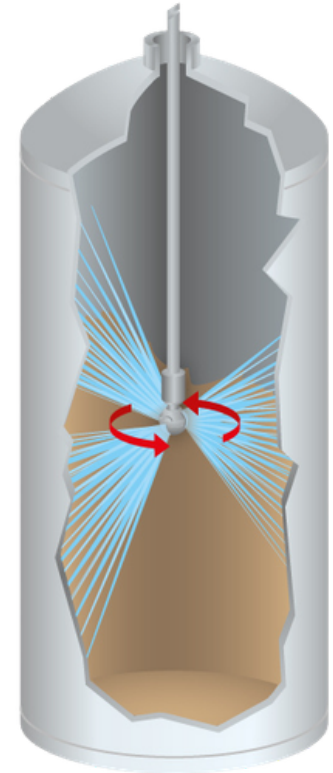

Cleaning Power

Spinners are suitable for tanks with diameters of up to 5.5 metres.

Class 1 **Light Soil:** All parts of the tank should be within the published cleaning diameter.

Class 2 **Moderate Soil:** We recommend keeping all parts of the tank within 75% of the published cleaning diameter.

Class 3 **Heavy Soil:** We recommend keeping all parts of the tank within 50% of the published cleaning diameter. In practice, this significantly reduces the suitability of spinners for very tough residues.

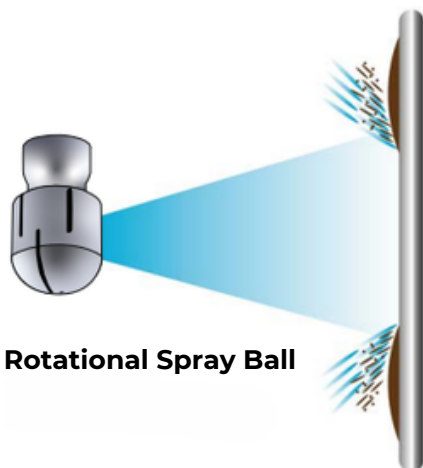

Rotational Spray Ball



RSB

Rotary Spray



THE
SPRAY NOZZLE
PEOPLE



Click [HERE](#) or scan to view this nozzle on our website

Class 1

Class 2

Class 3

Product Overview

The RSB is suitable for cleaning small and medium-sized vessels. It is self-cleaning and has a completely hygienic design, suitable for use in food and pharmaceutical applications.

Design Features

- Operating temperature: Up to 95°C (ATEX up to 60°C)
- Maximum operating temperature of 95°C
- Stainless steel construction for excellent corrosion resistance
- 316 stainless steel body with hardened 318 stainless steel bearings
- Laser-welded design for enhanced durability
- Internal and external surface finish of 0.8 microns Ra or better
- Manufactured from FDA-approved materials, suitable for Clean-in-Place (CIP) applications
- Self-cleaning bearings for reliable, low-maintenance operation
- Available with threaded or clip-on connections
- Weight: 0.35 - 1.03 kg

Spray Characteristics

- Spinning spray ball design providing a vigorous, dynamic cleaning action
- Flow rates: 16.7-313 L/min
- Pressure: 1-3 bar
- Max scrub diameter: 5.6 m
- Spray coverage options: 360°, 180° down, or 270° up

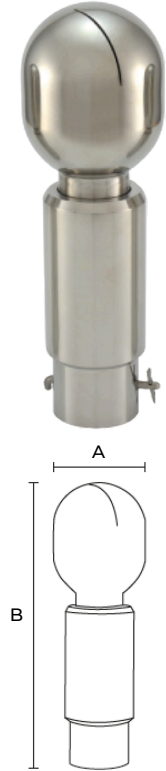

	Pressure in Bar			
	Connections	Weight (kg)	A	B
RSB25	3/8" Bsp or 1/2" clip on (m)	0.35	25mm	60mm
RSB45	1/2" or 3/4" BSP or clip on	0.48	45mm	155/137*
RSB65	1 1/4" Bsp or 1 1/2" clip on	1.03	65mm	200/183*

* Shorter distance is for threaded variants.

RSB Flow Rate & Cleaning Diameter Data

Model	Flow Rate, Wet & Scrub Diameter @ Bar											
	1 Bar			1.5 Bar			2 Bar			3 Bar		
	Flow Rate	Diameter Scrub	Diameter Wet	Flow Rate	Diameter Scrub	Diameter Wet	Flow Rate	Diameter Scrub	Diameter Wet	Flow Rate	Diameter Scrub	Diameter Wet
RSB25 180 down	16.7	0.8	4.3	20.3	1.1	4.8	25.5	1.2	5	31	1.4	5.4
RSB25 270 up and 360	30.5	0.8	4.3	36.8	1.1	4.8	46.5	1.2	5	58.3	1.4	5.4
RSB45 180 down	41.7	1.8	5.2	50	1.9	5.3	58.3	2	5.2	68.3	1.8	4.9
RSB45 270 up and 360	66.7	1.8	5.2	79.2	1.9	5.3	91.7	2	5.2	110	1.8	4.9
RSB65 180 down	113.3	3.8	5.5	125	4.2	5.7	165.8	4	6	200	3.7	5.6
RSB65 270 up and 360	183.3	3.8	5.5	221.7	4.2	5.7	253.3	4	6	313.3	3.7	5.6

Watch our short video series: Comparing CIP Systems

Scan the QR code or click [HERE](#) to watch our three-part comparison of the main types of tank wash nozzle heads. Discover how spinning spray balls compare with static spray balls, and how both perform against the powerful rotary jet head.



HydroWhirl® Disc (HWD) Rotary Spray



THE
SPRAY NOZZLE
PEOPLE



Click [HERE](#) or scan to view this nozzle on our website

Class 1

Class 2

Class 3

Product Overview

The HydroWhirl® Disc (HWD) tank cleaning head is a fully submersible, clog-resistant rotary head. It has the largest capacity free-spinning design with powerful flat spray nozzle inserts. It is suitable for cleaning small to medium-sized tanks with light to moderate soil.

Design Features

- Operating temperature: Up to 95°C (ATEX up to 60°C)
- Maximum operating temperature of 90°C
- Fully submersible, free-spinning tank cleaning head
- Fluid-driven and self-flushing operation for clog-resistant performance
- Constructed from FDA-compliant 316L stainless steel
- Hydrostatic, wear-free PTFE slide bearing for long service life
- Largest-capacity free-spinning design in its class
- Powerful flat spray nozzle inserts for effective cleaning

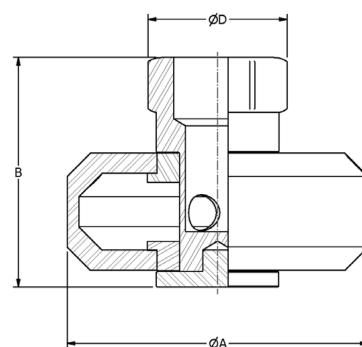

Spray Characteristics

- Vigorous spray action suitable for light to moderate soiling
- Flow rates: 96.3-227 L/min
- Pressure: 0.7-4 bar
- Spray diameter: 3.6 m
- Complete 360° spray coverage

HWD Dimensions (in mm)

Pipe Size	A	B	E	Weight (grams)
1"	99	73.7	40.6	1162

HydroWhirl® Disc Flow Rates

Materials: Body: 316L Stainless Steel | Slide-Bearing: PEEK

Nozzle Number	Female Connection Types	Spray Angles	Flow Rate (LPM) @ Pressure					Maximum Free Passage mm	Coverage Dia (m) @ 2 bar
			0.7 bar	1 bar	2 bar	3 bar	4 bar		
HWD-50	1" NPT	360°	96.3	115	162	197	227	3.30	3.6

HydroWhirl® Mini PVDF Rotary Spray



THE SPRAY NOZZLE PEOPLE



Click [HERE](#) or scan to view this nozzle on our website

Class 1

Class 2

Class 3

Product Overview

The Mini PVDF cleaning nozzle directs the cleaning water through a rotating head at the tip of the spray assembly and produces a vigorous moving spray action against all areas of the tank wall. Its compact size and tough material design makes it ideal for cleaning harsh substances such as chemical residues.

Design Features

- Operating temperature: Up to 95°C (ATEX up to 60°C)
- Maximum operating temperature of 90°C
- Compact, fluid-driven tank cleaning nozzle designed for confined spaces
- Self-flushing operation for reliable, maintenance-free performance
- Durable construction using FDA-compliant PVDF for excellent corrosion resistance
- Hydrostatic, wear-free slide bearing for long service life
- ½" NPT or BSP female threaded connections
- Integrated line strainer filtration (0.3 mm / 50 mesh)
- Additional connection types available on request

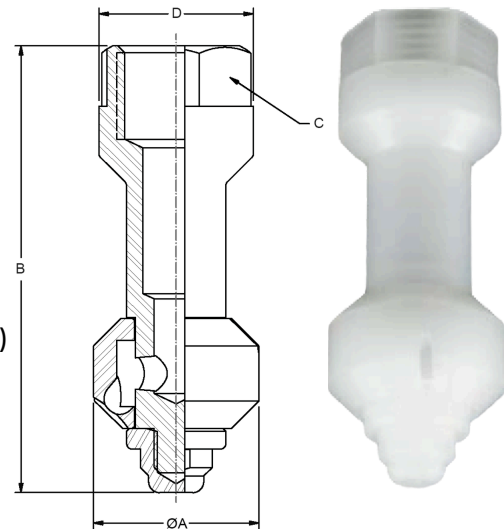

Spray Characteristics

- Vigorous moving spray action using impact and repetition
- Flow rates: 10.9-33.5 L/min
- Pressure: 0.5-4 bar
- Spray diameter: 2 m
- Complete 360° spray coverage

HYDROWHIRL® MINI Flow Rates

Standard Materials: PVDF

Female Connection Type	Nozzle No	Spray Angles	Flow Rate (L/Min) @ Bar						Coverage Dia. @ 3 Bar m
			0.5 bar	0.7 bar	1 bar	2 bar	3 bar	4 bar	
1/2" NPT/BSP	HWM 7.2	360°	10.9	13.0	15.8	23.0	28.7	33.5	2.0

*Flow rates represent threaded connections with a 360° spray angle.

*Flow rates may vary for other connection types and spray angles.

DIMENSIONS IN MILLIMETRES

Connection Size	A	B	C	Weight grams
1/2"	30.5	81.3	22.9	31.1

HydroWhirl® Mini SS

Rotary Spray



THE
SPRAY NOZZLE
PEOPLE



Click [HERE](#) or scan to view this nozzle on our website

Class 1

Class 2

Class 3

Product Overview

The HydroWhirl® Mini SS is a fluid-driven, compact tank cleaning nozzle that delivers vigorous, targeted spray action through a rotating head. Designed for food-grade environments, it provides powerful cleaning using impact and repetition, making it ideal for applications such as pipe cleaning, bottle rinsing and cleaning dispensing equipment.

Design Features

- Operating temperature: Up to 95°C (ATEX up to 60°C)
- Maximum operating temperature: 130°C
- Fluid-driven and self-flushing
- Durable, compact design
- FDA-compliant 316L stainless steel construction
- PEEK slide bearing for increased longevity
- Suitable for food-grade cleaning applications
- Threads available: 3/8" NPT/BSP female
- Line strainer filtration: 0.3 mm / 50 mesh
- Additional connection types available on request

Spray Characteristics

- Vigorous moving spray action
- Flow rates: 11.4 to 33.8 L/min
- Pressure: 0.5-4 bar
- Spray diameter: 1.8 m
- Complete 360° spray coverage (other spray angle patterns available upon request)

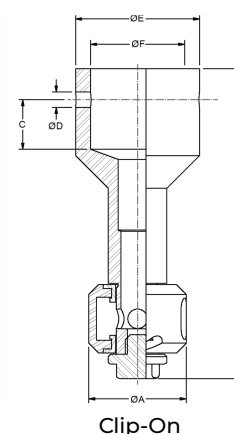
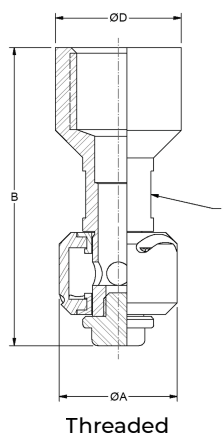

HYDROWHIRL® MINI Flow Rates

Materials: Body: 316L Stainless steel | Slide-Bearing: PEEK

Female connection Type	Nozzle No	Spray Angles	Flow Rate (L/Min) @ Bar						Coverage Dia. @ 3 Bar m
			0.5 bar	0.7 bar	1 bar	2 bar	3 bar	4 bar	
3/8" NPT/BSP 3/4" Tube Clip-on	HVM 7.5	360°	11.4	13.6	16.4	23.5	29.1	33.8	1.8

*Flow rates represent threaded connections with a 360° spray angle.

*Flow rates may vary for other connection types and spray angles.

Threaded Version

DIMENSIONS IN MILLIMETRES

Pipe Size	A	B	C	D	Weight grams
3/8"	20.3	50.8	12.7	17.8	73.7

Clip-On Version

DIMENSIONS IN MILLIMETRES

Tube Size	A	B	C	D	E	F	Weight grams
3/4"	20.3	63.5	10.2	25	25.4	20.3	31.1

HydroWhirl® Stinger (HWS2) Rotary Spray



THE
SPRAY NOZZLE
PEOPLE



Click [HERE](#) or scan to view this nozzle on our website

Class 1

Class 2

Class 3

Product Overview

The HWS2 tank delivers a robust cleaning action to the entire vessel. It is fluid-powered, with the rotary action driven by liquid pressure. It is a suitable choice of tank cleaner for small to medium-sized vessels with light to moderately tough residues.

Design Features

- Operating temperature: Up to 95°C (ATEX up to 60°C)
- Maximum operating temperature: 93°C
- 316 stainless steel construction, hygienic and chemical-resistant
- Patent-pending no-weld design for improved durability and reduced contamination risk
- Self-cleaning zirconia ceramic bearings for longevity and resistance
- Balanced bearing assembly positioned centrally for improved spray propagation
- Unique pipe thread technology flushes to minimise contamination and bacterial growth
- Filtration: 150 mesh for HWS2-4 and smaller, 200 mesh for HWS2.75 and larger

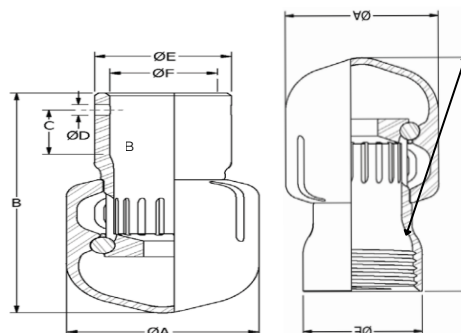

Spray Characteristics

- Flow rates: 4.15 – 380 L/min
- Pressure: 0.7-4 bar
- Max spray diameter: 4 m
- 360° spray coverage

HydroWhirl® Stinger Flow Rate & Coverage Data

Nozzle Number	Female Connection Types	Spray Angles	Flow Rate (LPM) @ Pressure					Maximum Free Passage	Coverage Dia (m) @ 2 bar
			0.7 bar	1 bar	2 bar	3 bar	4 bar		
HWS2-2.1	1/8" FNPT, BSP 3/8" Tube Clip-On	360°	4.15	4.92	6.83	8.27	9.48	0.64	0.6
HWS2-4			7.8	9.27	13	15.8	18.1	0.99	2
HWS2-7.5			14.6	17.4	24.3	29.6	34	1.6	2
HWS2-10	3/8" FNPT, BSP 1/2" Tube Clip-On	360°	18.8	22.6	32.1	39.5	45.7	0.61	2
HWS2-12			23.7	28.1	39	47.3	54.2	0.99	3
HWS2-17			32.8	39.1	54.9	67.1	77.3	2	3
HWS2-20	1/2" FNPT, BSP	360°	39	46.3	64.8	78.9	90.6	0.99	3
HWS2-26			49	58.8	83.6	103	119	1.63	3
HWS2-20			39	46.3	64.8	78.9	90.6	0.99	3
HWS2-26	3/4" FNPT, BSP 3/4" Tube Clip-On	360°	49	58.8	83.6	103	119	1.63	3
HWS2-33	1" FNPT, BSP 1" Tube Clip-On	360°	63.5	75.7	107	130	150	0.79	3
HWS2-55			105	126	177	217	251	1.63	4
HWS2-66			127	152	213	260	300	2.39	4
HWS2-84			165	195	272	331	380	3.18	4

HWS2 Weights & Dimensions (Threaded)

Pipe Size	A	B	E	Weight (grams)	Min Tank Entry Dia
1"	46.7	80	36.6	298	46.7
3/4"	34.3	69.1	29.2	146	34.3
1/2"	34.3	60.3	24.1	134	34.3
3/8"	21.6	45.2	19.1	40	21.6
1/8"	15.2	31.7	12.8	28	15.2

HWS2 Weights & Dimensions (Tube Clip-On)

Tube Size	A	B	C	D	E	F	Weight (g)	Min Tank Entry Dia (mm)
1"	46.7	86.4	21.3	3.96	33.5	25.4	340	46.7
3/4"	34.3	72.2	12.7	2.18	26.9	19	198	34.3
1/2"	21.6	48.3	12.4	2.18	21.3	12.7	85	30.2
3/8"	15.2	34.9	8.61	2.18	14.2	9.52	23	22.9

HydroWhirl® Poseidon® (HWP) Rotary Spray



THE
SPRAY NOZZLE
PEOPLE



Click [HERE](#) or scan to view this nozzle on our website

Class 1

Class 2

Class 3

Product Overview

The HydroWhirl® Poseidon® is an all-PTFE tank cleaning head. The all-PTFE design means it is suitable for use in highly corrosive and aggressive environments as PTFE is one of the most chemically inert compounds. The HWP's rotation is powered by the cleaning fluid and its slow rotation gives a robust clean for medium-sized tanks.

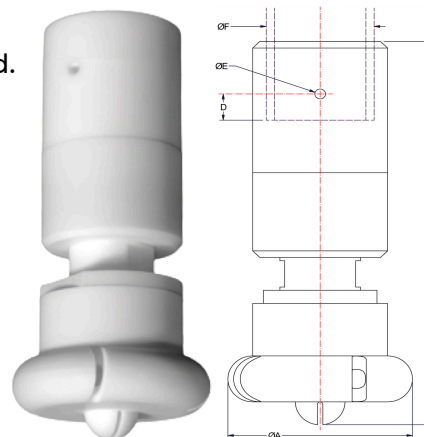

Design Features

- Operating temperature: Up to 95°C (ATEX up to 60°C)
- Max operating temperature: 93.3°C
- All-PTFE construction for excellent chemical and corrosion resistance
- Fully FDA-compliant for hygienic CIP applications
- Suitable for medium-sized tanks
- Available connections: threaded, pipe, tube, or DIN clip-on

Spray Characteristics

- Flow rates: 14.3 - 307 L/min
- Pressure: 0.5-4 bar
- Max spray diameter: 7.6 m
- Coverage: 360° spray pattern (other spray angles available upon request)

HydroWhirl Poseidon® Connections & Dimensions

Connection Type	Nozzle Number											
	HPW-10			HPW-32 HWP-28			HWP-32 HWP-37			HWP-48 HWP-55 HWP-65 HWP-73		
FNPT/BSP	1/4"	3/8"	1/2"	3/8"	1/2"	3/4"	1/2"	3/4"	1"	1"	1 1/4"	1 1/2"
Pipe Clip-On							X					
Dim F (mm)	13.7	17.3	21.3	17.3	21.3	26.7	21.3	26.7	33.5	33.5	42.2	48.3
Tube Clip-On	1/2"	3/4"		3/4"	1"		1"	1 1/4"		1 1/2"	1 3/4"	
Dim F (mm)	12.7	19.1		19.1	25.4		25.4	38.1		38.1	44.5	
DIN Clip On (DIN 11866 Part A)	DN10	DN15		DN15	DN20		DN20	DN25		DN40		
Dim F (mm)	13	19		19	23		23	29		41		

HydroWhirl Poseidon® Nozzle Flow Rates & Dimensions

Standard Materials: Nozzle: PTFE | Retaining Clip: 316 Stainless Steel

Nozzle Number	Spray Angle	Litres Per Minute @ BAR						Dimensions				Mass (g)	Coverage Diameter (m)	
		0.5 BAR	1 BAR	1.5 BAR	2 BAR	3 BAR	4 BAR	A	B	D	E			
HWP-10	360°	14.3	20.3	24.9	28.8	35.4	40.9	42.7	100.1	12.7	2.4	85	2.7	
HWP-23		30.3	43.1	52.9	61.2	75.2	87						3.4	
HWP-28		34.6	49.0	60.0	69.3	84.9	98	49.5	104.6	12.7	4.1	113	4.3	
HWP-32		37.5	53.8	66.5	77.2	95.4	111						4.3	
HWP-37		48.5	69.2	85.2	98.7	122	141	76.2	162.6	12.7	4.8	595	4.9	
HWP-48		66.0	94.0	116	134	165	191							7.3
HWP-55		75.4	107	132	153	188	218							
HWP-65		98.7	140	171	198	243	281	83.8	184.4	12.7	4.8	822		
HWP-73		108	153	187	216	265	307							7.6

Kompact Clean Rotary Spray



THE SPRAY NOZZLE PEOPLE



Click [HERE](#) or scan to view this nozzle on our website

Class 1

Class 2

Class 3

Product Overview

The Kompact Clean is a small, slimline rotary tank cleaner with an internal fluid-driven gearbox to ensure constant smooth operation with increases in pressure. Slow turning jets aid the scrubbing action and the clog-resistant design makes the Kompact Clean ideal for use in a range of industries such as brewing, food processing, pharmaceutical and chemical.

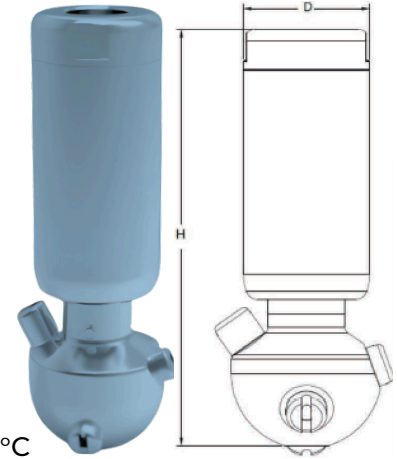

Design Features

- Compact, fluid-driven rotary tank cleaner
- Temperature ratings:
 - Standard Version: Max Operating 60°C & Max Ambient 100°C
 - High-Temperature Version: Max Operating 120°C & Max Ambient 200°C
- Manufactured from 316L stainless steel for hygienic and industrial use
- Internal fluid-driven gearbox for smooth, consistent operation
- Anti-clogging design for reliable performance in demanding environments
- Compact size for easy integration in confined spaces

Spray Characteristics

- Slow-turning, high-impact flat jets for enhanced scrubbing action
- Flow rates: 39 - 185 L/min
- Operating pressure range: 2-20 bar
- Max spray diameter: 6 m
- Full 360° spray coverage

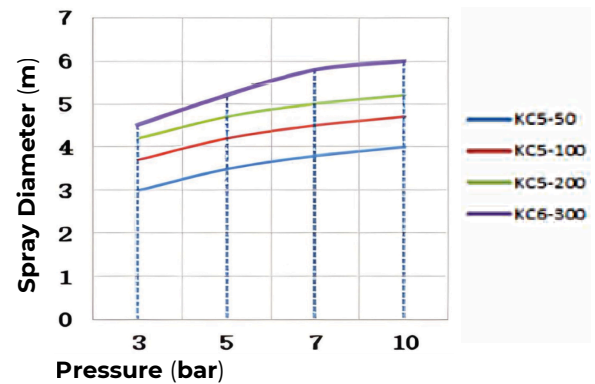

Kompact Clean Flow Rates & Dimensions

Standard Material: 316L Stainless Steel

Female thread (BSPP)	Model	Litres per minute @ BAR				Dimensions (mm)		Wt (kg)
		3 BAR	5 BAR	7 BAR	10 BAR	D	H	
3/4"	KC5-50	39	50	59	71	50	175	1.7
3/4"	KC5-100	78.8	100	120	144	50	175	1.7
3/4"	KC5-200	156	204	240	288	50	175	1.7
1"	KC5-300	232	300	355	424	50	185	2.9

EK Pop-Up Rotary Spray



THE
SPRAY NOZZLE
PEOPLE



Click [HERE](#) or scan to view this nozzle on our website

Class 1

Class 2

Class 3

Product Overview

The EK nozzle's spinning head automatically moves out from the nozzle body when fluid is turned on. In the retracted position the nozzle presents a smooth surface flush with the tank wall. The nozzle will deliver two rotating fan jets giving 270° coverage side to side (see diagram below). This makes the EK ideal for spot cleaning difficult-to-reach parts of the tank. The EK is used in conjunction with a primary tank cleaner.

Design Features

- Operating temperature: Up to 95°C (ATEX up to 60°C)
- Hygienic, retractable nozzle that remains flush with the tank wall when not in use
- 316 stainless steel construction - durable and corrosion-resistant
- Sanitary surface finish of 0.8 microns Ra or better
- Self-cleaning bearings for low maintenance
- Connections available: threaded, clip-on and welded
- Fully protected when submerged in retracted position

Spray Characteristics

- Vigorous rotating spray action
- Flow rates: 15.6 - 74.8 L/min
- Pressure: 1.5 - 7 bar
- 270° spray coverage (side-to-side fan jets)

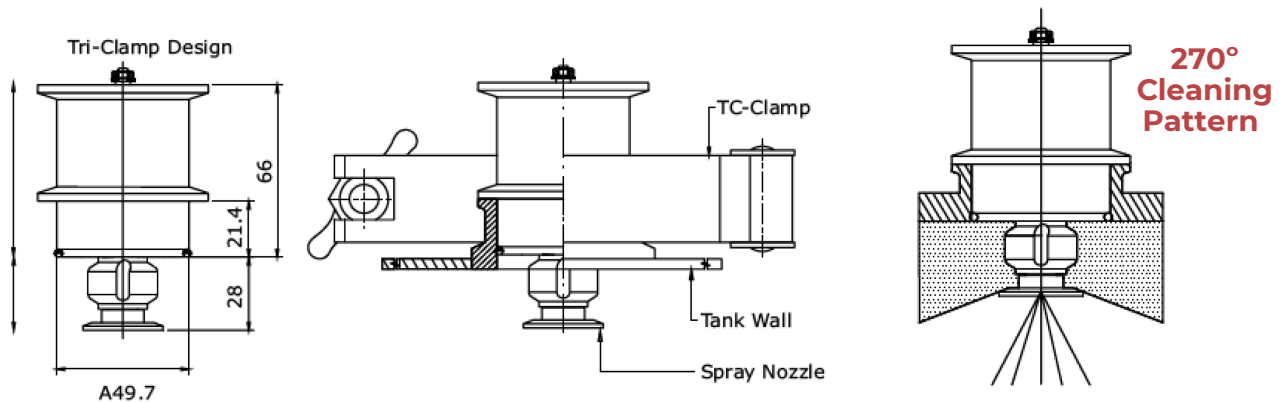

EK Pop-Up Flow Rates

Model Number	Spray Angle	Tri-clamp	Flow Rate @ BAR					Dimensions	
			1.5 BAR	2 BAR	3 BAR	5 BAR	7 BAR	H	H1
EK2.180.M2	270	2"TC	15.6	18	22.1	28.5	33.7	66mm	28mm
EK2.220.M2	270	2"TC	19.1	22	26.9	34.8	41.2	66mm	28mm
EK2.300.M2	270	2"TC	26	30	36.7	47.4	56.1	66mm	28mm
EK2.400.M2	270	2"TC	34.6	40	49	63.3	74.8	66mm	28mm

Spin-Atex Series Rotary Spray



THE
SPRAY NOZZLE
PEOPLE



Click [HERE](#) or scan to view
this nozzle on our website

Class 1

Class 2

Class 3

Product Overview

This range of ATEX-certified mini spinning spray balls is suitable for ATEX zones 1 & 2. Their compact size makes them ideal for processing equipment cleaning, including small tanks, pipes, bottles and dispensing equipment.



Design Features

- Operating temperature: up to 60°C
- Compact, durable construction suitable for small and medium tanks
- 316 stainless steel - corrosion-resistant and long-lasting
- Laser-welded body for maximum strength and hygienic design
- Internal and external surface finish of 0.8 microns Ra or better
- Compact form factor allows installation in confined spaces
- Threaded connections: 1/8", 1/4", 3/8", 1/2", 3/4", 1", 1 1/4" BSPP female
- Weld-on and clip-on options available on request
- ATEX-certified for use in hazardous zones 1 & 2

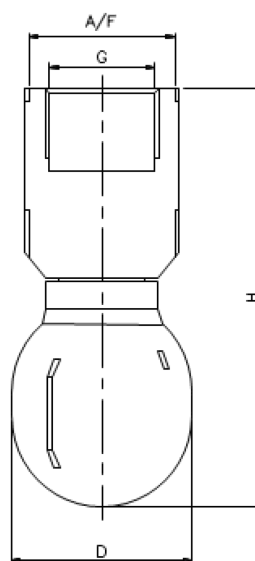

Spray Characteristics

- Vigorous rotary spray action
- Flow rates: 8.6 - 374.17 L/min
- Spray angles: 270° up, 270° down and 360°
- Max spray diameter: 5.5 m

Spin-Atex Series Flow Rates & Dimensions

Materials: 316 Stainless Steel

Model	Spray Angle	Connection (inch)	Litres per minute @ BAR					Dimensions (mm)		Coverage Diameter at 3 bar (m)
			1.5 BAR	2 BAR	3 BAR	5 BAR	7 BAR	H	D	
SX2.100	C/D/E	1/8	8.2	10.0	12.2	15.8	18.7	36.5	17	1.5
SX2.200	C/D/E	1/4"	17.3	20.0	24.5	31.6	37.4	50.0	21.5	1.8
SX2.300	C/D/E	3/8"	25.9	30.0	36.7	47.4	56.1	60.0	27.0	2.4
SX2.400	C/D/E	1/2" 3/4"	34.6	40.0	49.0	63.3	74.8	76.0	33.0	3.4
SX2.520	C/D/E	1/2" 3/4"	45.0	52.0	63.7	82.2	97.3			3.4
SX2.600	C/D/E	3/4"	52.0	60.0	73.5	94.9	112.3			3.4
SX2.800	C/D/E	3/4" 1"	69.3	80.0	98.0	126.5	149.7	100.0	41.0	4.0
SX3.100	C/D/E	1"	86.6	100.0	122.1	158.1	187.1	106.0	47.5	4.0
SX3.150	C/D/E	1"	129.9	150.0	183.7	237.2	280.6			4.0
SX3.200	C/D/E	1 1/4"	173.2	200.0	255.0	316.2	374.2	120.0	58.0	5.5

Spin-Atex NANO

Rotary Spray



THE
SPRAY NOZZLE
PEOPLE



Click [HERE](#) or scan to view this nozzle on our website

Class 1

Class 2

Class 3

Product Overview

The Spin-Atex NANO is a compact rotary tank cleaning head certified for use in ATEX Zone 0 environments. It is suitable for use in dryers, sprayers, pipes, small containers, filters and mixing vessels up to 1 m diameter.



Design Features

- Operating temperature: up to 60°C
- Maximum working temperature: 90 °C
- Maximum ambient temperature: 180 °C
- Highly compact rotary tank cleaning head, ideal for tight and enclosed spaces
- 316 stainless steel body and bearings
- Maintenance-free, self-cleaning operation
- Slotted spray for efficient and thorough coverage
- Dual-shaft with twin bearings for durability and flexibility
- Connection: DIN EN 228-G1/8 as standard (weld-on and clip-on options available on request)
- Operates in any orientation
- Robust construction suitable for industrial applications
- ATEX Zone 0 certified - safe for use in explosive atmospheres

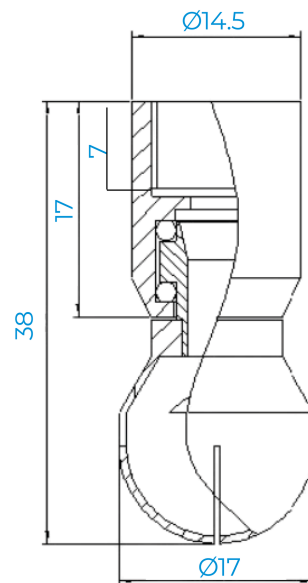

Dimensions (mm)



Spray Characteristics

- Flow rates: 7 - 40 L/min
- Working pressure: 1 - 7 bar
- Max spray diameter: 1m
- Standard spray angle: 360° (optional: 180° down, 270° down, 270° up)

Spin-Atex NANO Flow Rates

Materials: 316 SS | Bearings: 316 SS as standard

Others available, incl. Hastelloy C22 with Hastelloy C276 bearings

Nozzle Number	Pressure (bar)						Coverage Diameter at 3 bar (mm)
	2	3	4	5	6	7	
Nano 3.0mm	7	8.5	9.8	11.3	12.3	13	1000
Nano 3.5mm	11.3	12.3	14.3	15.8	17.5	18.8	
Nano 4.0mm	12.5	15.5	17.5	19	21	22	
Nano 4.5mm	16.3	19.9	23.2	25.2	28.1	30	
Nano 5.0mm	22	26.5	30.5	34	37	40	

Spin-Atex MICRO

Rotary Spray



THE
SPRAY NOZZLE
PEOPLE



Click [HERE](#) or scan to view this nozzle on our website

Class 1

Class 2

Class 3

Product Overview

The Spin-Atex MICRO is a compact rotary tank cleaning head certified for use in ATEX Zone 0 environments. It is suitable for use in dryers, sprayers, pipes, small containers, filters and mixing vessels up to 2 m diameter.



Design Features

- Operating temperature: up to 60°C
- Maximum operating temperature: 108 °C
- Maximum ambient temperature: 135 °C
- Compact, fluid-driven rotary tank cleaning head for small tanks and confined process equipment
- 316 stainless steel construction - durable, chemically resistant and built for industrial use
- Self-cleaning, low-maintenance design
- Slotted spray for enhanced impact and thorough coverage
- Dual-shaft with twin bearings for smooth operation and long life
- Connection: DIN EN 228-G3/8 standard (weld-on and clip-on options available on request)
- Operates in any orientation - vertical, horizontal, or inverted
- Compact and robust construction suitable for repeated use in harsh conditions
- ATEX Zone 0 certified - safe for hazardous, explosive environments



Spray Characteristics

- Flow rates: 5 - 89.5 L/min
- Working pressure: 1 - 15 bar
- Max spray diameter: 2 m
- Standard spray angle: 360° (optional: 180° down, 270° down, 270° up)

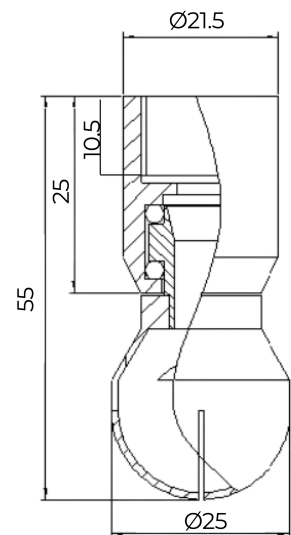

Dimensions (mm)

Spin-Atex MICRO Flow Rates

Materials: Nozzle: 316 SS | Bearings: 316 SS as standard
Others available, incl. Hastelloy C22 with Hastelloy C276 bearings

Model	Flow Rate (LPM) @ Pressure							Coverage Diameter at 3 bar (mm)
	1 bar	2 bar	3 bar	4 bar	5 bar	6 bar	7 bar	
Micro 3.0mm			7.5	9	10.53	11.53	12.5	2000
Micro 3.5mm		5	9	11.5	13	14.5	15.5	
Micro 4.0mm		11	13	15.5	17	18.5	19.5	
Micro 4.5mm		14	17.5	20.5	22.5	24	26	
Micro 5.0mm	16.5	19.3	22.3	25.8	28.5	30.8	33.3	
Micro 5.5mm	21.5	26.3	29.7	33.5	37.2	40	43	
Micro 6.0mm	24.5	32.5	35.3	40.5	44.8	48.5	52	
Micro 6.5mm	29	38.5	42	46	50.5	55	59	
Micro 7.0mm	32	43.3	51.4	58	62.9	68.1	71.6	
Micro 7.5mm	33.5	47	55.8	62.5	68.3	74.3	78	
Micro 8.0mm	37	50.3	61	70.5	77.3	83.5	89.5	

Spin-Atex MINI

Rotary Spray



THE
SPRAY NOZZLE
PEOPLE



Click [HERE](#) or scan to view this nozzle on our website

Class 1

Class 2

Class 3

Product Overview

The Spin-Atex MINI is a compact rotary tank cleaning head certified for use in ATEX Zone 0 environments. It is suitable for use in dryers, sprayers, pipes, small containers, filters and mixing vessels up to 4 m diameter.

Design Features

- Operating temperature: up to 60°C
- Max operating temperature: 90 °C
- Max ambient temperature: 180 °C
- Compact, fluid-powered rotary spray head for small to medium-sized tanks, pipes and process vessels
- 316 stainless steel construction - durable and chemically resistant
- Self-cleaning, maintenance-free design for reliable operation
- Slotted spray for high-impact cleaning
- Dual-shaft design with twin stainless steel bearings for smooth, extended-life rotation
- Connection: DIN EN 228-G3/4 (weld-on and clip-on options available on request)
- Operates in any orientation
- ATEX Zone 0 certified - safe for explosive environments

Spray Characteristics

- Flow rates: 40.5 - 133 L/min
- Working pressure: 1 - 15 bar
- Max spray diameter: 4 m
- Standard spray angle: 360° (optional: 180° down, 270° down, 270° up)

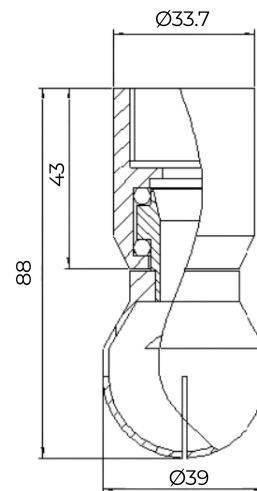

Dimensions (mm)

Spin-Atex MINI Flow Rates

Materials: Nozzle: 316 SS | Bearings: 316 SS as standard

Others available, incl. Hastelloy C22 with Hastelloy C276 bearings

Model	2 bar	3 bar	4 bar	5 bar	6 bar	7 bar	Coverage Diameter at 3 bar (mm)
Mini 7.5mm	40.5	48	55.5	63	68	71.5	4000
Mini 8.0mm	45.5	55	64.5	70	74.3	82.5	
Mini 8.5mm	59	71	81	90.5	96	101.5	
Mini 9.0mm	71	79	85	90	95	100	
Mini 9.5mm	74	84.5	97	107.5	116.5	125.5	
Mini 10.0mm	79	94	103	112	121	130	
Mini 10.5mm	76	92.3	105.1	116.4	127.3	133	

Spin-Atex MAXI

Rotary Spray



THE
SPRAY NOZZLE
PEOPLE



Click [HERE](#) or scan to view this nozzle on our website

Class 1

Class 2

Class 3

Product Overview

The Spin-Atex MAXI is a compact rotary tank cleaning head certified for use in ATEX Zone 0 environments. It is suitable for use in dryers, sprayers, pipes, small containers, filters and mixing vessels up to 5 m diameter.

Design Features

- Largest model in the Spin-Atex range, designed for tanks up to 5 metres in diameter
- Operating temperature: up to 60°C
- Max operating temperature: 90 °C
- Max ambient temperature: 180 °C
- 316 stainless steel construction - robust and corrosion-resistant
- Self-cleaning, maintenance-free design for reliable, uninterrupted operation
- Slotted spray for vigorous cleaning action
- Dual-shaft design with dual stainless steel bearings for smooth, balanced rotation
- Connection: DIN EN 228-G 1½" (weld-on and clip-on options available)
- Operates in any orientation - horizontal, vertical, or inverted
- ATEX Zone 0 certified - safe for explosive or hazardous environments

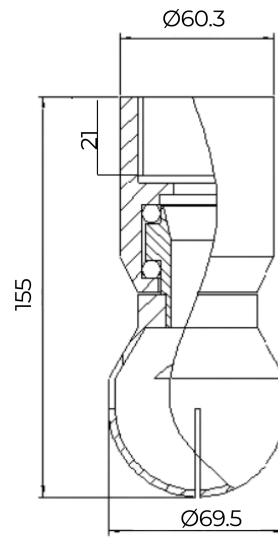

Dimensions (mm)



Spray Characteristics

- Flow rates: 110 - 380 L/min
- Working pressure: 1 - 15 bar
- Standard spray angle: 360° (optional: 180° down, 270° down, 270° up)
- Max spray diameter: 5 m

Spin-Atex MAXI Flow Rates

Materials: Nozzle: 316 SS | Bearings: 316 SS as standard

Others available, incl. Hastelloy C22 with Hastelloy C276 bearings

Model	2 bar	3 bar	4 bar	5 bar	6 bar	7 bar	Scrubbing Diameter at 3 bar (mm)
Maxi 14.mm	110	134	155	165	190	193	4000
Maxi 16.mm	134	162	190	217	235	251	
Maxi 18mm	165	199	235	266	293	313	5000
Maxi 20 mm	195	240	280	315	350	380	

Static Cleaners Introduction



THE
SPRAY NOZZLE
PEOPLE

Static cleaning nozzles, also known as stationary nozzles, are non-rotating spray devices with no moving parts, making them highly durable and low-maintenance. They are ideal for hygienic applications where simplicity and reliability are key.

This category includes a variety of wide-angle spiral nozzles and nozzle manifolds that deliver omnidirectional cleaning sprays, suitable for tanks up to 4 metres in diameter. Also featured is the clog-resistant HydroClaw™ cleaning head, designed for challenging environments where blockage is a concern.

A broad selection of static spray balls is also available, offering 360°, 180° upward, or 180° downward micro-jet spray patterns. These are suited to tanks up to 5 metres in diameter and are widely used across industries due to their effective, all-round cleaning coverage.

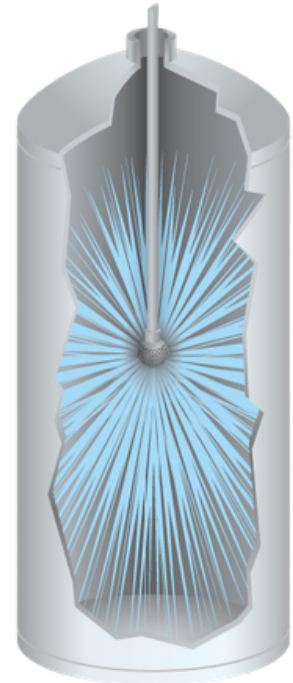

Cleaning Solutions for Small Vessels

For applications requiring compact form factors, the TW spiral series provides excellent coverage with a narrow profile, allowing installation through small vessel openings such as bottles.

Additionally, the range includes the Retractor nozzle, which retracts to sit flush with the tank wall - ideal for systems where a rotary spray head may also be required.

Cleaning Power

Class 1 **Light Soil:** All parts of the tank should be kept within the published cleaning diameter.

Class 2 **Moderate Soil:** We recommend keeping all parts of the tank within 50% of the published cleaning diameter.

Class 3 **Heavy Soil:** We do not recommend static cleaning solutions. In some cases, they may still be used, but they typically require very long cleaning times to break down residues and therefore become highly inefficient.

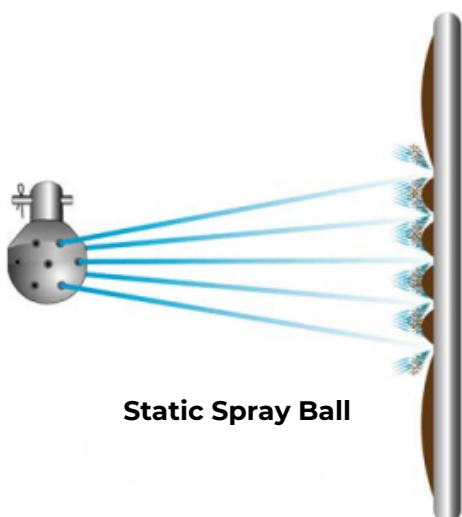

Static Spray Ball



SVSTW

Static Spray Ball



THE
SPRAY NOZZLE
PEOPLE



Click [HERE](#) or scan to view this nozzle on our website

Class 1

Class 2

Class 3

Product Overview

These spray balls are a versatile tank cleaning system that are very low maintenance. The selection in the table below is by no means exhaustive, by changing the position and pattern of the holes it is possible to design spray balls that meet the exact requirements of the tank cleaning application.



Design Features

- Operating temperature: Up to 95°C (ATEX up to 60°C)
- Multiple precision-drilled holes give an omni-directional spray pattern
- No moving parts, ensuring long life and low maintenance
- Available in female-threaded and clip-on connection types

Spray Characteristics

- Low-impact or rinse cleaning
- Flow rates: 20 - 900 L/min
- Pressure: 1 - 3.5 bar
- Rinse diameter: 6.8 m
- Max rinse diameter: 6.8 m
- Available in 360°, 180° up and down, 270° up and down

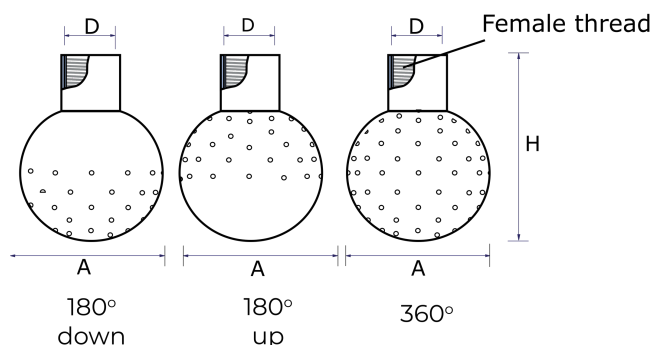

THREADED

SVSTW Flow Rate, Cleaning Diameter & Dimensions

Model	Thread Size	Pattern (°)	Flow rate (l/min) at bar						Rinse Dia @ 1 bar	Dimensions (mm)		
			1 bar	1.5 bar	2 bar	2.5 bar	3 bar	3.5 bar		A	H	Hole Size
SVSTW293	1 1/4"	180 down	265	324.6	374.8	419	459	495.8	6.8m	90	150	2.5
SVSTW293	3/4"	180 down	153.3	187.8	216.8	242.4	265.6	286.9	5m	65	94	2.5
SVSTW293	1/2"	180 down	51.7	63.3	73.1	81.7	89.5	96.7	6.4m	50	91	1.6
SVSTW293	1/4"	180 down	23.3	28.6	33	36.9	40.4	43.7	4.4m	28	65	1.3
SVSTW294	1 1/4"	180 up	211.7	259.2	299.3	334.7	366.6	396	4.4m	90	150	2.5
SVSTW294	3/4"	180 up	145	177.6	205.1	229.3	251.1	271.3	4.4m	65	94	2.5
SVSTW294	1/2"	180 up	50	61.2	70.7	79.1	86.6	93.5	6m	50	91	1.6
SVSTW294	1/4"	180 up	20	24.5	28.3	31.6	34.6	37.4	3.2m	28	65	1.3
SVSTW295	1 1/4"	360	496.7	608.3	702.4	785.3	860.3	929.2	6.2m	90	150	2.5
SVSTW295	3/4"	360	220	269.4	311.1	347.9	381.1	411.6	2.6m	65	94	2.5
SVSTW295	1/2"	360	90	110.2	127.3	142.3	155.9	168.4	4.8m	50	91	1.6
SVSTW295	1/4"	360	30	36.7	42.4	47.4	52	56.1	2m	28	65	1.3

SVSTW

Static Spray Ball



THE
SPRAY NOZZLE
PEOPLE



Click [HERE](#) or scan to view this nozzle on our website

Class 1

Class 2

Class 3

CLIP-ON

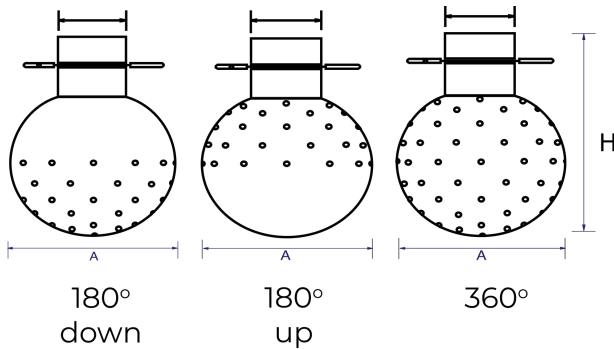

As well as female-threaded connections, spray balls are also available with pipe or tube clip-on connectors. The diameter D refers to the outside diameter of the connecting tube, with the inside diameter being 2 mm smaller.

SVSTW Flow Rate, Cleaning Diameter & Dimensions

Model	Tube Size (mm)	Pattern (°)	Flow rate (l/min) at bar						Rinse Dia @ 1 bar	Dimensions (mm)		
			1 bar	1.5 bar	2 bar	2.5 bar	3 bar	3.5 bar		A	H	Hole Size
SVSTW290	60.3	180 down	148.3	181.7	209.8	234.5	256.9	277.5	3.4m	120	150	2
SVSTW290	38	180 down	193.3	236.8	273.4	305.7	334.9	361.7	9.8m	65	94	2.5
SVSTW290	28	180 down	170	208.2	240.4	268.8	294.4	318	6.4m	65	91	2.5
SVSTW290	22	180 down	38.3	46.9	54.2	60.6	66.4	71.7	3.8m	40	65	1.6
SVSTW291	60.3	180 up	170	208.2	240.4	268.8	294.4	318	4.6m	120	150	2
SVSTW291	38	180 up	135	165.3	190.9	213.5	233.8	252.6	4.8m	65	94	2.5
SVSTW291	28	180 up	170	208.2	240.4	268.8	294.4	318	6m	65	91	2.5
SVSTW291	22	180 up	38.3	46.9	54.2	60.6	66.4	71.7	4m	40	65	1.6
SVSTW292	60.3	360	316.7	387.8	447.8	500.7	548.5	592.4	6m	120	150	2
SVSTW292	38	360	305	373.5	431.3	482.2	528.3	570.6	6m	65	94	2.5
SVSTW292	28	360	261.7	320.5	370.1	413.7	453.2	489.5	3.6m	65	91	2.5
SVSTW292	22	360	61.7	75.5	87.2	97.5	106.8	115.4	3.2m	40	65	1.6



Watch our short video series: *Comparing CIP Systems*

Scan the QR code or click [HERE](#) to watch our three-part comparison of the main types of tank wash nozzle heads. Discover how spinning spray balls compare with static spray balls, and how both perform against the powerful rotary jet head.



LEM Static



THE
SPRAY NOZZLE
PEOPLE

Click [HERE](#) or scan to view
this nozzle on our website



Class 1

Class 2

Class 3

Product Overview

The LEM is an omnidirectional nozzle manifold that holds 6 spiral spray nozzles to give a 360° spray pattern. The clog-resistant nature of spiral nozzles means the LEM is a useful system for tank cleaning applications using recirculated water that may contain particulates.

Design Features

- Operating temperature: Up to 95°C (ATEX up to 60°C)
- Six nozzles arranged in a cluster to project spray in all directions
- Each nozzle in the stationary cluster is a BETE clog-resistant spiral nozzle from the TF Series
- Can be supplied with a range of alternative BETE nozzles to suit specific applications
- Female connection

Spray Characteristics

- Flow rates: 16.0 - 597 L/min (special flow rates available; special tips available upon request)
- Pressure: 0.7 - 7 bar
- Max rinse diameter: 4.9 m
- Omni-directional coverage

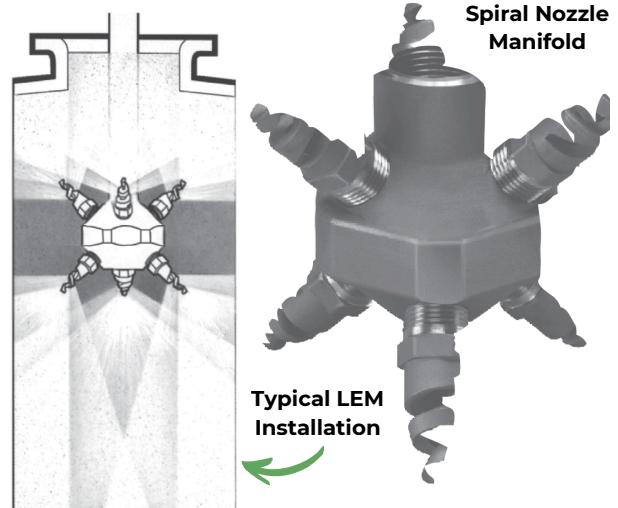

LEM Coverage Chart When Spraying at 3 - 4 bar

Female Pipe Size	Nozzle Number	Scrubbing Diameter (mm)	Rinsing Diameter ((mm)
3/4"	LEM6	450	900
	LEM8	900	1800
	LEM10	1400	2700
1"	LEM12	2000	4000
	LEM14	2100	4200
	LEM16	2200	4400
	LEM20	2400	4900

LEM Flow rates and dimensions

Spherical 360° Spray Angle 3/4" and 1" BSP or NPT

Standard Materials: Brass, 316 SS, PVC and PTFE

Female Pipe Size	Female Pipe Size	K Factor	Flow Rate l/min								A (mm)	Weight	
			0.7 bar	1 bar	1.5 bar	2 bar	3 bar	4 bar	5 bar	7 bar		(kg) Metal	(g) Plas
3/4"	LEM6	19.1	16.0	19.3	23.4	27.1	33.2	38.3	42.8	50.6	114	1.02	170
	LEM8	36.5	30.5	36.5	44.7	51.6	63.2	72.9	81.5	96.5			
	LEM10	57.0	47.7	57.0	69.8	80.6	98.7	114	127	151			
1"	LEM12	82.0	68.6	82.0	100	116	142	164	183	217	133	1.87	312
	LEM14	111	92.7	111	136	157	192	222	248	293			
	LEM16	144	120	144	176	203	249	287	321	380			
	LEM20	226	189	226	276	319	391	451	504	597			

Flow Rate (l/min) = K √ bar

- Dimensions are approximate. Please check with SNP for critical dimension applications.
- Spray angle performance varies with pressure. Please contact SNP for specific data on critical applications.

CLUMP Static



THE
SPRAY NOZZLE
PEOPLE



Click [HERE](#) or scan to view this nozzle on our website

Class 1

Class 2

Class 3

Product Overview

The CLUMP manifold can hold 6 spray nozzles of various sizes and types. This allows for the generation of 360-degree spray patterns.

Design Features

- Operating temperature: Up to 95°C (ATEX up to 60°C)
- Six nozzles arranged in a cluster to project spray in all directions
- Each nozzle in the stationary cluster is a BETE clog-resistant full-cone nozzle from the MaxiPass® series
- Can be supplied with a range of other BETE nozzles to suit specific applications

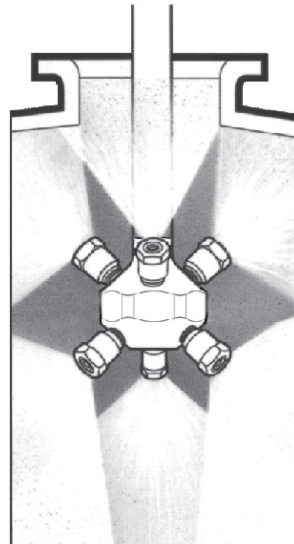

Typical CLUMP Installation

Spray Characteristics

- Flow rates: 28.1 to 290 L/min (Special flow rates available)
- Pressure: 0.7 - 5 bar
- Spherical, omni-directional coverage

CLUMP- Coverage Chart When Spraying at 3 - 4 bar

Female Pipe Size	Nozzle Numbe	Scrubbing Diameter(mm)	Rinsing Diame-ter ((mm)
3/4"	CLUMP125	1200	2400
	CLUMP156	1200	3700
	CLUMP187	1800	4300
1"	CLUMP187	1800	4300
	CLUMP218	2400	4300
	CLUMP2500	3000	4900

Clump Flow rates and dimensions

Spherical 360° Spray Angle 3/4" and 1" BSP or NPT

Female Pipe Size	Female Pipe Size	K Factor	Flow Rate l/min						A (mm)	(kg) Metal	Weight (kg) Plas
			0.7 bar	1 bar	2 bar	3 bar	4 bar	5 bar			
3/4"	CLUMP125	33.2	28.1	33.2	46.0	55.6	63.7	70.8	120	1.29	0.22
	CLUMP156	52.7	44.6	52.7	73.2	88.2	101	112			
	CLUMP187	76.2	65.7	76.2	106	128	146	163			
1"	CLUMP187	76.2	65.7	76.2	106	128	146	163	146	2.34	0.4
	CLUMP218	121	103	121	168	203	232	258			
	CLUMP250	136	115	136	188	228	261	290			

Flow rate (l/min) = K(bar)^{1/2}

Standard Materials: Brass, inox 316, PVC and PTFE

- Dimensions are approximate. Please check with SNP for critical dimension applications.
- Spray angle performance varies with pressure. Contact SNP for specific data on critical applications.

HydroClaw™

Clog-Resistant Static



THE
SPRAY NOZZLE
PEOPLE



Click [HERE](#) or scan to view this nozzle on our website

Class 1

Class 2

Class 3

Product Overview

The HydroClaw™ is the world's first clog-resistant 360° tank cleaning head, developed to solve the problem of spray ball and tank cleaning heads clogging with particulates such as pips, pith and seeds in the wash water. The patented design gives a vigorous, high flow rate cleaning action suitable for vessels up to 3 metres in diameter. Fully hygienic, it is ideal for use in sectors such as winemaking and brewing where clogging can be a particular problem.



Design Features

- Recommended installation position: 0.6–1.0 m below the tank top
- Operating temperature: Up to 95°C (ATEX up to 60°C)
- Maximum operating temperature: 288.9 °C
- Patented, non-mechanical design with no moving parts for maximum reliability
- Allows the passage of particles up to 7 mm in diameter
- Manufactured from FDA-compliant 316L stainless steel
- Laser-welded construction for strength and long service life
- Compact design suitable for installation through 63.5 mm or 76 mm diameter openings
- Self-draining and self-flushing design for improved hygiene and reliability

Spray Characteristics

- Vigorous rinsing performance for effective removal of solids and residues
- Flow rates: 119–442 L/min
- Optimised for low-pressure, high-flow operation
- Best performance at 2 bar
- 360° omni-directional coverage for complete tank cleaning

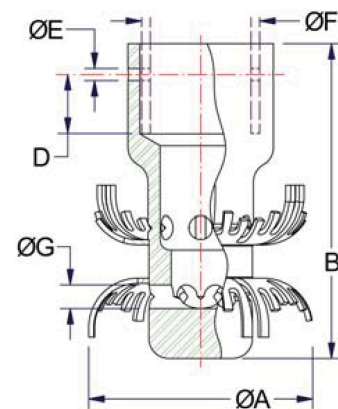

HydroClaw™ Flow Rates & Dimensions

Standard Material: 316L Stainless Steel

Clip-on flow rates may vary depending on actual O.D. of installation tube or pipe

Female connections	Nozzle Number	Litres per minute @ BAR				Dimensions (mm)					Free Pass (mm)	Wt (g)	Coverage Diameter @ 2 BAR (m)	
		1.5 BAR	2 BAR	2.5 BAR	3 BAR	A	B	D	E	F				
3/4" NPT/BSP													416	
G3/4	HC-42	119	136	152	166	60.5	91.2	-	-	-	6.4	413	2.4	
1" Tube Weld-On												325		
1 1/2" Tube Clip-On							102			38.1		504		
1" Tube Clip-On										25.4		391		
DN20 Tube Clip-On	HC-42	125	145	161	176	60.5	91.2	19.1	4.1	23.1	6.4	416	2.4	
3/4" Pipe Clip-On										26.7		382		
1" NPT												649		
G1	HC-100	279	322	360	394	73.2	102	-	-	-	7.6	635	3.0	
1 1/2" Tube Weld-On												425		
1 1/2" Tube Clip-On										38.1		527		
DN40 Tube Clip-On	HC-100	312	361	403	442	73.2	102	19.1	4.1	40	7.6	437	3.0	
1" Pipe Clip-On										33.5		598		

TW Spiral Static



THE SPRAY NOZZLE PEOPLE



Click [HERE](#) or scan to view this nozzle on our website

Class 1

Class 2

Class 3

Product Overview

The TW is a compact, wide-angle spiral spray nozzle designed for cleaning tanks and vessels with restricted access. Its unique spiral construction produces a spray pattern of up to 270°, making it highly effective for a range of industrial cleaning applications. Thanks to its clog-resistant design, the TW is ideal for use with recirculated wash water and fits easily into tanks with small or narrow openings. Simple to maintain and energy efficient, the TW offers reliable, consistent cleaning in challenging environments.



Design Features

- Operating temperature: Up to 95°C (ATEX up to 60°C)
- Maximum operating temperature: 288.9 °C
- Compact, wide-angle spiral spray nozzle design
- Clog-resistant construction suitable for use with recirculated wash water
- Spiral construction promotes improved flow and self-cleaning capability
- Compact form factor designed for restricted or narrow tank openings
- Opposing spray configuration for thorough internal coverage
- Simple design requiring minimal maintenance
- Easy access for straightforward inspection and servicing
- Energy-efficient operation to reduce overall running costs

Spray Characteristics

- Flow rates: 11.4–260 L/min
- Pressure: 0.7 - 5 bar
- Spray diameter: 3 m
- Spray angles: up to 270°

TW Tank Washing Coverage Chart

Spraying at 2-3 bar

Pipe Size	Nozzle Number	Scrubbing Diameter (mm)	Rinsing Diameter (mm)
3/8"	TW12	380	760
	TW14	460	1200
	TW16	610	1500
	TW20	910	2100
1"	TW1	2400	6100

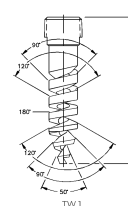
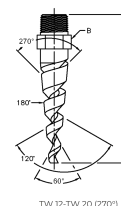
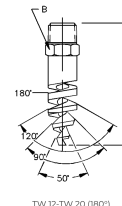
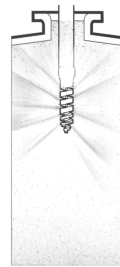

TW Flow Rates & Dimensions

TW 180° and 270° Spray Angles, 3/8" and 1" Pipe Sizes, BSP or NPT
Standard Materials: Brass, 316 Stainless Steel

Male Pipe Size	Nozzle Number	Available Spray Angles	K	Flow Rate (l/min) at bar						Dimension (mm)			Wt (g)		
				0.7 bar	1 bar	2 bar	3 bar	4 bar	5 bar	Ori Dia	Free Pass	A		B	C
3/8"	TW12	180° 270°	13.7	11.4	13.7	19.3	23.7	27.3	30.6	4.83	3.3				
	TW14	180° 270°	18.5	15.4	18.5	26.1	32	36.9	41.3	5.59	3.3	73	17.5		49.6
	TW16	180° 270°	24.2	20.2	24.2	34.2	41.8	48.3	54	6.35	3.3				
	TW20	180° 270°	37.6	31.5	37.6	53.2	65.1	75.2	84.1	7.87	3.3				
1"	TW1	270°	116	97.2	116	164	201	232	260	14.2	5.08			146.1	298

Retractor Static



THE
SPRAY NOZZLE
PEOPLE



Click [HERE](#) or scan to view
this nozzle on our website

Class 1

Class 2

Class 3

Product Overview

The new Retractor nozzle is a compact, efficient retractable cleaner. By using the operating pressure, the cleaning head will extend and retract and once extended will be in its working position. The stroke length can be customised to suit all applications.

The Retractor is suitable for all cleaning agents, is FDA compliant and can be integrated into an automated cleaning solution. The design is adaptable for sterile operation on request. In the standard installation position, the nozzle is completely self-cleaning.



Design Features

- Compact, retractable tank cleaning head
- Operating temperature: Up to 95°C (ATEX up to 60°C)
- Max operating temperature: 180°C
- Max tank temperature during production: 360°C
- Max ambient temperature: 108°C
- Construction materials:
 - 316L stainless steel (Hastelloy C4, 904L, 1.4435 on request)
 - Bearings: PTFE
 - Spring: 1.4310 stainless steel
- Lubricated by cleaning medium
- Various mounting options: flange, hose nozzle, inline, or tangential
- Non-rotating piston rod option
- Customisable stroke and mounting length to suit different tank sizes
- Integration options: park area, ball valve, sensors for start/end position
- Fully self-cleaning in standard installation position
- FDA-compliant and suitable for all cleaning agents
- ATEX Zone 0 certification available
- Suitable for automated and sterile cleaning applications

Spray Characteristics

- Activated and driven by cleaning medium pressure
- Stroke: up to 1000 mm
- Mounting length: up to approx. 2000 mm
- Working pressure: 2 - 8 bar
- Drive and speed determined by cleaning medium and spray head design
- Spray pattern and operation vary depending on the spraying device version

IBC Cleaning Kit

Clean IBCs In-House

SNP

THE
SPRAY NOZZLE
PEOPLE

Click [HERE](#) or scan to view
this nozzle on our website



Class 1

Class 2

Class 3

Product Overview

For businesses cleaning between 5–50 IBCs per week, outsourcing to a specialist cleaning company is expensive while manual cleaning is time-consuming, water and energy intensive and inconsistent. SNP's IBC Cleaning Kit provides a practical, economical solution for in-house cleaning, delivering a controlled, repeatable process that reduces contamination risks and improves workplace safety.

Benefits

- Automates IBC tote cleaning and frees up staff
- Delivers a complete 360° clean of interior surfaces
- Reduces contamination risk
- Provides a reliable, repeatable, controlled cleaning process
- Improves workplace health and safety
- Removes even tough residues
- Prevents IBC damage and leakage through reduced wear
- Reduces water usage
- Easy to maintain

Design Features

- Easy to use: set up and walk away
- Complete kit with pump, lance, lid and Orbitor Eco nozzle cleaning head (see Page 10) plus pipework and fittings
- Materials and design suitable for use in even the most hygienic applications
- Orbitor Eco head delivers cleaning in under 5 minutes
- Flow rate: 58.3 L/min at 5 bar



Manual washing cannot reach every part of the IBC and exposes the operator to splashback risk

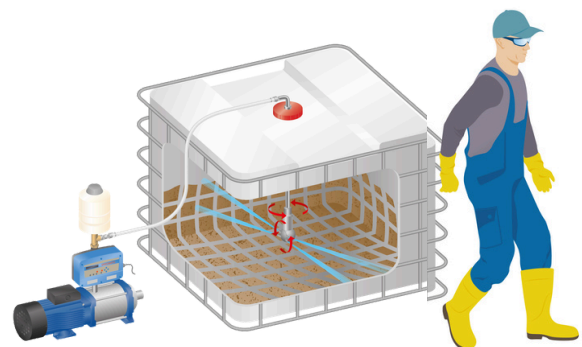

The IBC Kit keeps operators safe and enables them to get on with other tasks.



Watch our short video series:

IBC Tote Cleaning Systems Explained | In-House CIP Guide



Scan the QR code or click [HERE](#) to watch our short video series on professional in-house IBC tote cleaning. Discover how automated IBC cleaning systems work and get answers to your most common questions.

Custom Cleaning Solutions



THE
SPRAY NOZZLE
PEOPLE

Our standard range of products accommodates the vast majority of tank cleaning scenarios. However, certain specialised cleaning situations require the development of custom products. With our technical expertise and engineering know-how, we can quickly design and produce unique solutions to meet specific cleaning challenges.

Special Cleaning Heads

Some tank cleaning applications require a non-standard approach. SNP can engineer custom solutions to focus cleaning power exactly where it is needed. We have assisted customers with particularly challenging tasks, such as cleaning ready-mix concrete trucks and sticky resin vessels. In some cases, this involves modifying a standard product, while in others we have developed entirely new designs.

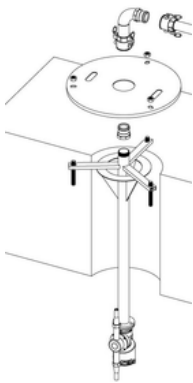

Lances & Downpipes

Correct positioning of tank cleaners inside the vessel is often critical. The Spray Nozzle People bring many years of experience in designing and fabricating lances and downpipes to securely hold all types of our cleaning heads.

Swing Arms

For open tanks, cleaning heads are often mounted on swing arms, allowing them to be easily moved to the tank edge for maintenance.

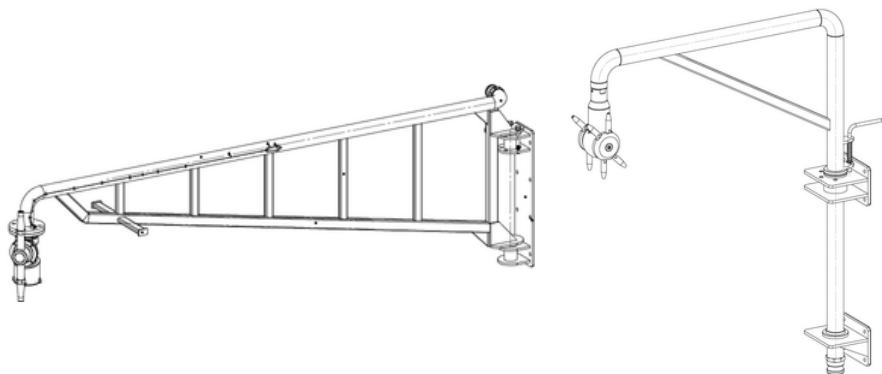

Pumps

We supply a range of pumps, with selection made in consideration of overall system performance. For tank washing applications, this ensures the pump can reliably deliver the required flow and pressure for effective, consistent cleaning, rather than being specified in isolation.

About Us: Our Company & Suppliers



THE
SPRAY NOZZLE
PEOPLE

The Spray Nozzle People (SNP) are specialist suppliers of spray nozzle and tank cleaning systems. We work with organisations of all sizes, from niche specialists to global engineering leaders. ISO certified and experienced in managing stringent documentation requirements, we have the expertise to design and deliver even the most complex custom tank cleaning solutions.

Key Suppliers

We have distribution agreements with several high-quality manufacturers of tank cleaning heads and spray nozzles. Primarily, we hold exclusive distribution rights for the Dasic range of Orbitors.



To complement this range, we also supply BETE's spinning and static spray balls, including the patent-pending HydroClaw™ - the world's first 360° clog-resistant tank cleaner. BETE are based in Greenfield, Massachusetts, USA.



The Group

The Spray Nozzle People are part of The Spray People Group (SPG) - a collection of business units, each specialising in distinct product areas.





THE
SPRAY NOZZLE
PEOPLE

The Go-to People for
SUCCESSFUL SPRAY ENGINEERING

**Effective & Efficient
Tank Cleaning Systems
for all Industries**

FOOD PROCESSING
BREWING & DISTILLING
WASTEWATER TREATMENT
CHEMICAL / PETROCHEMICAL
PHARMACEUTICAL

GET IN TOUCH TODAY

+44 (0)1273 400092

enquiries@spray-nozzle.co.uk

www.spray-nozzle.co.uk