



THE
SPRAY NOZZLE
PEOPLE

HydroClaw™

Clog Resistant
360°



TANK WASH

DESIGN FEATURES

- ✓ Clog-resistant design with no moving parts
- ✓ Allows passage of particles up to 7 mm diameter, three times the free passage of a comparable spray ball
- ✓ Made from FDA compliant 316L stainless steel for use in food-grade and sanitary Clean-In-Place (CIP) applications
- ✓ Low pressure/high flow operation.
- ✓ Self-draining and self-flushing
- ✓ Laser-welded for durability
- ✓ Fits through 63.5 or 76 mm diameter opening

SPRAY CHARACTERISTICS

- ✓ Vigorous rinsing action quickly flushes solids and contamination from vessels
- ✓ Complete 360° omni-directional coverage
- ✓ Optimum cleaning performance at 2 bar
- ✓ Recommended installation 0.6 - 1.0m vertically below top of tank
- ✓ Flow rates: 119-442 l/min



The HydroClaw is the world's first clog resistant 360° tank cleaning head. It was developed to solve the problem of spray ball and tank cleaning heads clogging with particulates such as pips, pith and seeds in the wash water.

The patented design gives a vigorous, high flow rate cleaning action suitable for vessels up to 3 metres in diameter.

It is ideal for use in sectors such as winemaking and brewing where clogging can be a particular problem.

CALL NOW : +44 (0) 1273 400092

www.spray-nozzle.co.uk

The Go-to People for spray nozzle solutions

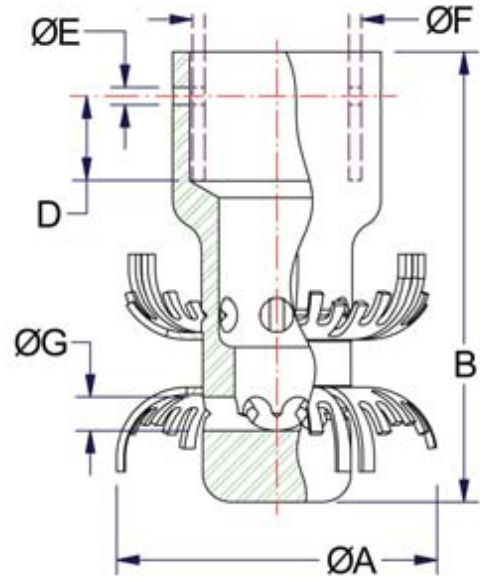

HydroClaw flow rates and dimensions

Standard Material: 316L Stainless Steel

Clip-on flow rates may vary depending on actual O.D. of installation tube or pipe

Female connections	Nozzle Number	Litres per minute @ BAR				Dimensions (mm)					Free Pass (mm)	Wt (g)	Coverage Diameter @ 2 BAR (m)
		1.5 BAR	2 BAR	2.5 BAR	3 BAR	A	B	D	E	F			
3/4" NPT/BSP												416	
G3/4	HC-42	119	136	152	166	60.5	91.2	-	-	-	6.4	413	2.4
1" Tube Weld-On												325	
1 1/2" Tube Clip-On							102			38.1		504	
1" Tube Clip-On	HC-42	125	145	161	176	60.5		19.1	4.1	25.4	6.4	391	2.4
DN20 Tube Clip-On							91.2			23.1		416	
3/4" Pipe Clip-On										26.7		382	
1"NPT												649	
G1	HC-100	279	322	360	394	73.2	102	-	-	-	7.6	635	3.0
1 1/2" Tube Weld-On												425	
1 1/2" Tube Clip-On										38.1		527	
DN40 Tube Clip-On	HC-100	312	361	403	442	73.2	102	19.1	4.1	40	7.6	437	3.0
1" Pipe Clip-On										33.5		598	

Ask our technical sales engineers about additional products and services to optimise your spraying process.

Spray Calibration Solutions

Easy-to-use, fast measurement solutions to ensure accurate nozzle installation and maintenance, reduce water wastage and identify nozzle wear.



Spray Pattern & Droplet Distribution



Nozzle Flow Calibrators



Nozzle Cleaning Kit

Complete Spray Bars

Tailored nozzle selections and spray bar designs that integrate seamlessly with your new or existing setup.

- ✓ Expert nozzle selection and placement
- ✓ Efficient spray coverage
- ✓ Fast turnaround time
- ✓ Reduced design burden
- ✓ High-quality spray bars



Complete Custom Spraying Systems

Complete spraying systems built around your goals and application.

- ✓ Tailored upstream components supplied individually or as part of complete system
- ✓ Custom pipework, pumps, tanks, sensors, valves, heating, control panels and more
- ✓ Seamless integration with existing processes
- ✓ Built to budget and ROI targets
- ✓ End-to-end support: design, install, maintain

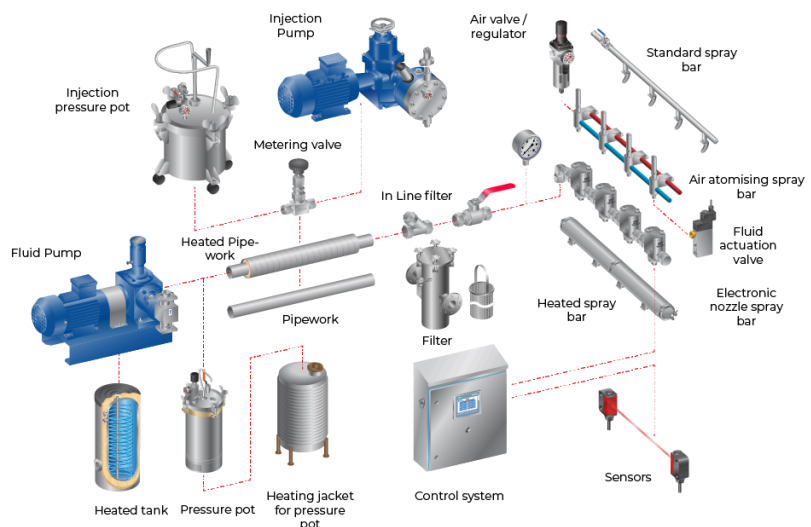

THE GO-TO PEOPLE FOR SUCCESSFUL SPRAY ENGINEERING