



THE
SPRAY NOZZLE
PEOPLE

HydroClaw™

Clog Resistant
360°



TANK WASH

DESIGN FEATURES

- ✓ Clog-resistant design with no moving parts
- ✓ Allows passage of particles up to 7 mm diameter, three times the free passage of a comparable spray ball
- ✓ Made from FDA compliant 316L stainless steel for use in food-grade and sanitary Clean-In-Place (CIP) applications
- ✓ Low pressure/high flow operation.
- ✓ Self-draining and self-flushing
- ✓ Laser-welded for durability
- ✓ Fits through 63.5 or 76 mm diameter opening

SPRAY CHARACTERISTICS

- ✓ Vigorous rinsing action quickly flushes solids and contamination from vessels
- ✓ Complete 360° omni-directional coverage
- ✓ Optimum cleaning performance at 2 bar
- ✓ Recommended installation 0.6 - 1.0m vertically below top of tank
- ✓ Flow rates: 119-442 l/min



The HydroClaw is the world's first clog resistant 360° tank cleaning head. It was developed to solve the problem of spray ball and tank cleaning heads clogging with particulates such as pips, pith and seeds in the wash water.

The patented design gives a vigorous, high flow rate cleaning action suitable for vessels up to 3 metres in diameter.

It is ideal for use in sectors such as winemaking and brewing where clogging can be a particular problem.

CALL NOW : +44 (0) 1273 400092

www.spray-nozzle.co.uk

The Go-to People for spray nozzle solutions

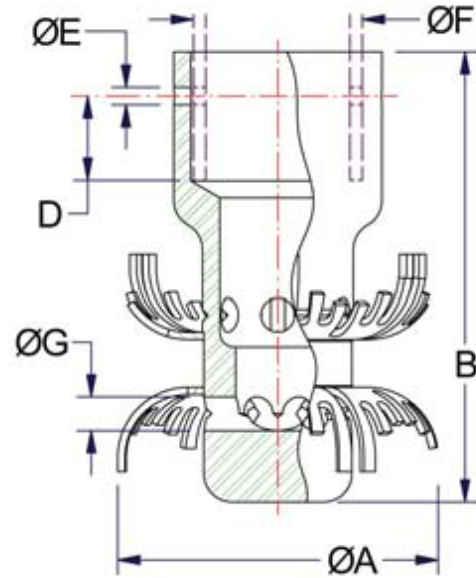

HydroClaw flow rates and dimensions

Standard Material: 316L Stainless Steel

Clip-on flow rates may vary depending on actual O.D. of installation tube or pipe

Female connections	Nozzle Number	Litres per minute @ BAR				Dimensions (mm)					Free Pass (mm)	Wt (g)	Coverage Diameter @ 2 BAR (m)	
		1.5 BAR	2 BAR	2.5 BAR	3 BAR	A	B	D	E	F				
3/4" NPT/BSP													416	
G3/4	HC-42	119	136	152	166	60.5	91.2	-	-	-	6.4	413	2.4	
1" Tube Weld-On												325		
1 1/2" Tube Clip-On							102			38.1		504		
1" Tube Clip-On										25.4		391		
DN20 Tube Clip-On	HC-42	125	145	161	176	60.5	91.2	19.1	4.1	23.1	6.4	416	2.4	
3/4" Pipe Clip-On										26.7		382		
1"NPT												649		
G1	HC-100	279	322	360	394	73.2	102	-	-	-	7.6	635	3.0	
1 1/2" Tube Weld-On												425		
1 1/2" Tube Clip-On										38.1		527		
DN40 Tube Clip-On	HC-100	312	361	403	442	73.2	102	19.1	4.1	40	7.6	437	3.0	
1" Pipe Clip-On										33.5		598		