

LP

Low Profile

DESIGN FEATURES

- Provides effective cleaning with low water consumption
- Interchangeable family of shower nozzles
- Self-aligning
- Orifice designed for efficient cleaning

SPRAY CHARACTERISTICS

Spray patterns: Straight Jet and Flat Fan.

Spray Angles: 0°, 30° and 60°

Flow rates: 0.041 to 43.9 gpm
0.162 to 155 l/min.

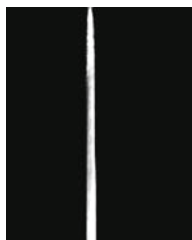

0° Fan

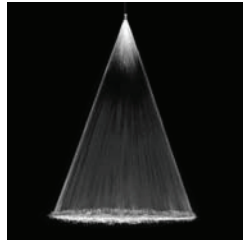

30° Fan

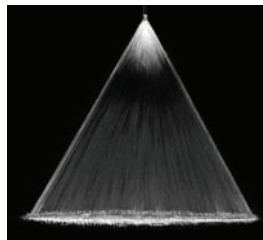

60° Fan



Retaining Ring

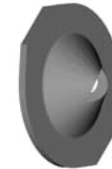

LP nozzle



Gasket

Dimensions are approximate. Check with BETE for critical dimension applications.

LP Flow Rates and Dimensions Fan and Straight Jet, 0°, 30° and 60° Spray Angles

Nozzle Number	Available Spray Angle 0° 30° 60°	K Factor	LITRES PER MINUTE @ BAR					Equivalent Orifice Dia. (mm)
			3 bar	4 bar	5 bar	10 bar	30 bar	
LP0041	0°	0.0937	0.162	0.187	0.209	0.296	0.513	0.4
LP0073	0°	0.167	0.290	0.334	0.374	0.529	0.916	0.6
LP0090	0°	0.205	0.354	0.409	0.458	0.647	1.12	0.7
LP013	0°	0.298	0.517	0.597	0.667	0.943	1.63	0.8
LP023	0° 30° 60°	0.520	0.901	1.04	1.16	1.65	2.85	1.0
LP033	0° 30° 60°	0.744	1.29	1.49	1.66	2.35	4.07	1.2
LP043	0° 30° 60°	0.967	1.68	1.93	2.16	3.06	5.30	1.5
LP08	0° 30° 60°	1.83	3.17	3.66	4.09	5.79	10.0	2.0
LP12	0° 30° 60°	2.82	4.89	5.65	6.32	8.93	15.5	2.5
LP20	0° 30° 60°	4.50	7.79	8.99	10.1	14.2	24.6	3.0
LP31	60°	7.16	12.4	14.3	16.0	22.7	39.2	4.0
LP49	60°	11.2	19.3	22.3	25.0	35.3	61.2	5.0
LP78	60°	17.9	31.0	35.7	40.0	56.5	97.9	6.0
LP99	60°	22.5	38.9	45.0	50.3	71.1	123	7.0
LP124	60°	28.2	48.9	56.5	63.2	89.3	155	8.0

$$\text{Flow Rate (l/min)} = K \sqrt{\text{bar}}$$

Standard Materials: 316 Stainless Steel

Spray angle performance varies with pressure. Contact BETE for specific data on critical applications.

SPECIAL PURPOSE

TO ORDER: specify pipe size, connection type, nozzle number, spray angle, and material.