



THE  
**SPRAY NOZZLE**  
PEOPLE

## SPIN-ATEX

Small Rotary Nozzle  
ATEX Certified  
Zones 1 & 2



# TANK WASH

## DESIGN FEATURES

- ✓ Certified for ATEX Zones 1&2
- ✓ Cleans more quickly and uses less water and lower pressure than static tank wash heads
- ✓ Compact design
- ✓ Internal and external surface finish of 0.8 microns Ra or better for hygienic applications
- ✓ Suitable for use in food, chemical and paper making industries
- ✓ Laser welded design for durability
- ✓ 316 stainless steel construction - corrosion resistant
- ✓ Threads available: 1/8", 1/4", 3/8", 1/2", 3/4", 1", 1 1/4" BSPP female (weld on and clip on by request)

## SPRAY CHARACTERISTICS

- ✓ Vigorous spray action
- ✓ Spray Angles: 270°, 360°
- ✓ Flow Rates: 8.6 - 374.17 L/min
- ✓ Material: 316 ss
- ✓ Clean tanks from 1500mm to 5500mm diameter



The Spin-Atex series is a range of ATEX certified mini spinning spray balls suitable for ATEX zones 1 & 2. The nozzles direct the cleaning water through a rotating head at the tip of the spray assembly and produce a vigorous moving spray action against all areas of the tank wall.

The spray pattern from the nozzles uses impact and repetition to wash the tank quickly. Their compact size makes them ideal for processing equipment cleaning, including small tanks, pipes, bottles and dispensing equipment.

CALL NOW : +44 (0) 1273 400092

[www.spray-nozzle.co.uk](http://www.spray-nozzle.co.uk)

The Go-to People for successful spray engineering

## Spin-Atex Flow Rates and Dimensions

Materials: 316 Stainless Steel

Model	Spray Angle	Connection (inch)	Litres per minute @ BAR					Dimensions (mm)		Coverage Diameter (m)
			1.5 BAR	2 BAR	3 BAR	5 BAR	7 BAR	H	D	
<b>SX2.100</b>	C/D/E	1/8	8.2	10.0	12.2	15.8	18.7	36.5	17	1.5
<b>SX2.200</b>	C/D/E	1/4"	17.3	20.0	24.5	31.6	37.4	50.0	21.5	1.8
<b>SX2.300</b>	C/D/E	3/8"	25.9	30.0	36.7	47.4	56.1	60.0	27.0	2.4
<b>SX2.400</b>	C/D/E	1/2" 3/4"	34.6	40.0	49.0	63.3	74.8	76.0	33.0	3.4
<b>SX2.520</b>	C/D/E	1/2" 3/4"	45.0	52.0	63.7	82.2	97.3			3.4
<b>SX2.600</b>	C/D/E	3/4"	52.0	60.0	73.5	94.9	112.3			3.4
<b>SX2.800</b>	C/D/E	3/4" 1"	69.3	80.0	98.0	126.5	149.7	100.0	41.0	4.0
<b>SX3.100</b>	C/D/E	1"	86.6	100.0	122.1	158.1	187.1	106.0	47.5	4.0
<b>SX3.150</b>	C/D/E	1"	129.9	150.0	183.7	237.2	280.6			
<b>SX3.200</b>	C/D/E	1 1/4"	173.2	200.0	255.0	316.2	374.2	120.0	58.0	5.5

## Dimensions

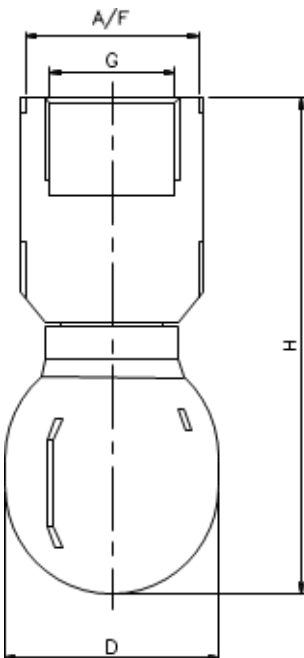

## Angles

Coverage Type	Spray Angle
	<b>270°</b>
	<b>270°</b>
	<b>360°</b>

